

Corridor Title Co. GF# 21-0364-C

DECLARATION OF COVENANTS,
CONDITIONS AND RESTRICTIONS

HICKORY RIDGE
BEXAR COUNTY, TEXAS

Declarant: 181 AND 1604 LAND DEVELOPMENT PARTNERS, LTD., a Texas limited partnership

This Declaration of Covenants, Conditions and Restrictions may be used only in connection with the residential community known as Hickory Ridge in Bexar County, Texas and the operation of Elmendorf Hickory Ridge Community Association, Inc.

DECLARATION OF COVENANTS, CONDITIONS AND RESTRICTIONS

HICKORY RIDGE
TABLE OF CONTENTS

	<u>Page</u>
ARTICLE 1 DEFINITIONS	5
ARTICLE 2 GENERAL AND USE RESTRICTIONS	9
2.01 General	9
2.02 Conceptual Plans	10
2.03 Single-Family Residential Use	10
2.04 Subdividing.....	11
2.05 Hazardous Activities.....	12
2.06 Insurance Rates.....	12
2.07 Mining and Drilling	12
2.08 Noise	12
2.09 Outdoor Speakers.....	12
2.10 Animals - Household Pets	13
2.11 Rubbish and Debris.....	13
2.12 Maintenance	13
2.13 Antennas	14
2.14 Location of Permitted Antennas.....	15
2.15 Signs.....	15
2.16 Flags – Approval Requirements	16
2.17 Flags – Installation and Display.....	16
2.18 Tanks	17
2.19 Temporary Structures	17
2.20 Unsightly Articles; Vehicles.....	18
2.21 Mobile Homes, Travel Trailers and Recreational Vehicles	18
2.22 Basketball Goals; Permanent and Portable	18
2.23 Compliance with Restrictions.....	19
2.24 Liability of Owners for Damage to Common Area	19
2.25 No Warranty of Enforceability	20
2.26 Party Wall Fences	20
2.27 Lift Station, Drainage Facilities, Drainage Pond.....	21
2.28 Water Quality Easement	Error! Bookmark not defined.
ARTICLE 3 CONSTRUCTION RESTRICTIONS.....	21
3.01 Approval for Construction	21

3.02	Rentals	21	
3.03	Garages	22	
3.04	Fences; Sidewalks	22	
3.05	Driveways	22	
3.06	Dwelling Size; Building Materials	22	
3.07	Alteration or Removal of Improvements.....	23	
3.08	Trash Containers	23	
3.09	Drainage.....	23	
3.10	Construction Activities.....	23	
3.11	Roofing.....	23	
3.12	Swimming Pools.....	24	
3.13	Compliance with Setbacks	24	
3.14	Solar Energy Device.....	24	
3.15	Rainwater Harvesting Systems.....	25	
3.16	Xeriscaping	26	
ARTICLE 4 WHISPER RESIDENTIAL COMMUNITY ASSOCIATION, INC. Error! Bookmark not defined.			
4.01	Organization.....	28	
4.02	Membership	28	
4.03	Governance.....	29	
4.04	Voting Rights	29	
4.05	Powers	30	
4.06	Acceptance of Common Area.....	33	
4.07	Indemnification	33	
4.08	Insurance.....	34	
4.09	Bulk Rate Contracts	34	
4.10	Community Systems.....	35	
4.11	Protection of Declarant’s Interests.....	35	
4.12	Administration of Common Area	36	
ARTICLE 5 INSURANCE			36
5.01	Insurance.....	36	
5.02	Restoration.....	36	
5.03	Mechanic’s and Materialmen’s Lien.....	37	
ARTICLE 6 COVENANT FOR ASSESSMENTS			37
6.01	Assessments	37	
6.02	Maintenance Fund	38	
6.03	Regular Annual Assessments	38	
6.04	Working Capital Assessment.....	38	

6.05	Special Assessments	39
6.06	Individual Assessments	39
6.07	Amount of Assessment	40
6.08	Late Charges	40
6.09	Owner’s Personal Obligation; Interest.....	40
6.10	Assessment Lien and Foreclosure	41
6.11	Exempt Property	42
6.12	Fines and Damages Assessment.....	43
 ARTICLE 7 ARCHITECTURAL CONTROL COMMITTEE.....		44
7.01	Construction of Improvements.....	45
7.02	Architectural Control Committee.....	45
 ARTICLE 8 MORTGAGE PROVISIONS.....		48
8.01	Notice of Action.....	48
8.02	Examination of Books.....	48
8.03	Taxes, Assessments and Charges	49
 ARTICLE 9 GENERAL PROVISIONS.....		49
9.01	Term.....	49
9.02	Eminent Domain	49
9.03	Amendment.....	49
9.04	Roadway and Utility Easements.....	50
9.05	Enforcement	50
9.06	Higher Authority	50
9.07	Severability.....	50
9.08	Conflicts	50
9.09	Gender.....	51
9.10	Acceptance by Grantees	51
9.11	Damage and Destruction	51
9.12	No Partition	52
9.13	Notices	52
9.14	View Impairment	52
9.15	Safety and Security	52
 ARTICLE 10 EASEMENTS.....		53
10.01	Right of Ingress and Egress.....	53
10.02	Reserved Easements.....	53
10.03	Utility Easements.....	53
10.04	Subdivision Entry and Fencing Easement.....	54
10.05	Landscape and Monument Sign Easement	54
10.06	Declarant as Attorney in Fact.....	54

ARTICLE 11 DEVELOPMENT RIGHTS	55
11.01 Development by Declarant.....	55
11.02 Special Declarant Rights.....	55
11.03 Addition of Land	55
11.04 Withdrawal of Land.....	56
11.05 Assignment of Declarant’s Rights.....	56
ARTICLE 12 DISPUTE RESOLUTION.....	56
12.01 Agreement to Encourage Resolution of Disputes Without Litigation.....	56
12.02 Dispute Resolution Procedures	58

DECLARATION OF COVENANTS, CONDITIONS AND RESTRICTIONS
HICKORY RIDGE

This Declaration of Covenants, Conditions and Restrictions (the "**Declaration**") is made by **181 AND 1604 LAND DEVELOPMENT PARTNERS, LTD**, a Texas limited partnership (the "**Declarant**"), and is as follows:

RECITALS:

A. This Declaration is filed with respect to that certain tract of land located in Bexar County, Texas described on Exhibit "A" (the "**Property**") and further illustrated on the conceptual plan attached hereto as Exhibit "B" and establishing Hickory Ridge. Declarant is the owner of the Property.

B. Declarant desires to create and carry out a uniform plan for the development, improvement, and sale of the Property.

C. By the filing of this Declaration, Declarant serves notice that the Property is subject to the terms and provisions of this Declaration.

NOW, THEREFORE, it is hereby declared: (i) that the Property (or any portion thereof) will be held sold, conveyed, and occupied subject to the following covenants, conditions and restrictions which will run with such portions of the Property and will be binding upon all parties having right, title, or interest in or to such portions of the Property or any part thereof, their heirs, successors, and assigns and will inure to the benefit of each owner thereof; and (ii) that each contract or deed conveying the Property (or any portion thereof) will conclusively be held to have been executed, delivered, and accepted subject to the following covenants, conditions and restrictions, regardless of whether or not the same are set out in full or by reference in said contract or deed.

This Declaration uses notes (text set apart in boxes) to illustrate concepts and assist the reader. If there is a conflict between any note and the text of the Declaration, the text will control.

ARTICLE 1
DEFINITIONS

Unless the context otherwise specifies or requires, the following words and phrases when used in this Declaration will have the meanings hereinafter specified:

"Applicable Law" means the statutes and public laws and ordinances in effect at the time a provision of the Restrictions is applied, and pertaining to the subject matter of the Restriction provision. Statutes and ordinances specifically referenced in the Restrictions are "Applicable Law" on the date of the Restrictions, and are not intended to apply to the Property

if they cease to be applicable by operation of law, or if they are replaced or superseded by one or more other statutes or ordinances.

“Architectural Control Committee” or **“ACC”** means the committee created pursuant to this Declaration to review and approve plans for the construction, placement, modification, alteration or remodeling of any Improvements on a Lot. As provided in Article 7 below, the Declarant acts as the ACC and the ACC is not a committee of the Association until the Declarant has assigned its right to appoint and remove all ACC members to the Association in a Recorded a written instrument.

“Assessment” or **“Assessments”** means assessments imposed by the Association under this Declaration.

“Assessment Unit” has the meaning set forth in *Section 6.07(b)*.

“Association” means Elmendorf Hickory Ridge Community Association, Inc., a Texas non-profit corporation, which will be created by Declarant to exercise the authority and assume the powers specified in *Article 3* and elsewhere in this Declaration.

“Board” means the Board of Directors of the Association.

“Bulk Rate Contract” or **“Bulk Rate Contracts”** means one or more contracts which are entered into by the Association for the provision of utility services or other services of any kind or nature to the Lots. The services provided under Bulk Rate Contracts may include, without limitation, cable television services, telecommunications services, internet access services, “broadband” services, security services, trash pickup services, propane service, natural gas service, lawn maintenance services, wastewater services, and any other services of any kind or nature which are considered by the Board to be beneficial.

“Bylaws” means the Bylaws of the Association as adopted and as amended from time to time.

“Certificate” means the Certificate of Formation of the Association, filed in the Office of the Secretary of State of Texas, as the same may be amended from time to time.

“Common Area” means any property and facilities that the Association owns or in which it otherwise holds rights or obligations, including any property or facilities held by the Declarant for the benefit of the Association or its Members. Common Area includes any property that the Association holds under a lease, license, or any easement in favor of the Association. Some Common Area will be solely for the common use and enjoyment of the Owners, while other portions of the Common Area may be for the use and enjoyment of the Owners and members of the public.

“Community Manual” means the community manual, which may be initially adopted and recorded by the Declarant as part of the initial project documentation for the benefit of the

Association. The Community Manual may include the Bylaws, Rules and Regulations and other policies governing the Association. The Community Manual may be amended, from time to time, by the Declarant during the Development Period. Upon expiration or termination of the Development Period, the Community Manual may be amended by a Majority of the Board.

“Community Systems” means any and all cable television, telecommunications, alarm/monitoring, internet, telephone or other lines, conduits, wires, amplifiers, towers, antennae, satellite dishes, equipment, materials and installations and fixtures (including those based on, containing and serving future technological advances not now known), if installed by Declarant or pursuant to any grant of easement or authority by Declarant within the Property.

“Declarant” means 181 AND 1604 LAND DEVELOPMENT PARTNERS, LTD, a Texas limited partnership, its successors or assigns; provided that any assignment(s) of the rights of 181 AND 1604 LAND DEVELOPMENT PARTNERS, LTD, a Texas limited partnership, as Declarant, must be expressly set forth in writing and Recorded.

Declarant enjoys special privileges to help protect its investment in the Property. These special rights are described in this Declaration. Many of these rights do not terminate until either Declarant: (i) has sold and settled all Lots which may be created out of the Property; or (ii) voluntarily terminates these rights by a Recorded written instrument.

“Design Guidelines” means the standards for design, construction, landscaping, and exterior items placed on any Lot adopted pursuant to *Section 7.02(c)*, as the same may be amended from time to time. The Design Guidelines may consist of multiple written design guidelines applying to specific portions of the Property. Declarant may adopt the initial Design Guidelines. Notwithstanding anything in this Declaration to the contrary, Declarant will have no obligation to establish Design Guidelines.

“Development Period” means the period of time beginning on the date when this Declaration has been Recorded, and ending at such time as Declarant no longer owns the Property, unless earlier terminated by Declarant. Declarant may terminate the Development Period by an instrument executed by Declarant and Recorded. The Development Period is the period in which Declarant reserves the right to facilitate the development, construction, and marketing of the Property, and the right to direct the size, shape and composition of the Property.

“Homebuilder” means an Owner (other than the Declarant) who acquires a Lot or any portion of the Property for the construction of a single family residence for resale to a third party.

“Improvement” means every structure and all appurtenances of every type and kind, whether temporary or permanent in nature, including, but not limited to, buildings, outbuildings, storage sheds, patios, tennis courts, sport courts, recreational facilities, swimming pools, putting greens, garages, driveways, parking areas and/or facilities, storage buildings,

sidewalks, fences, gates, screening walls, retaining walls, stairs, patios, decks, walkways, landscaping, mailboxes, poles, signs, antennae, exterior air conditioning equipment or fixtures, exterior lighting fixtures, water softener fixtures or equipment, and poles, pumps, wells, tanks, reservoirs, pipes, lines, meters, antennas, towers and other facilities used in connection with water, sewer, gas, electric, telephone, regular or cable television, or other utilities.

"Lot" means any portion of the Property designated by Declarant or as shown as a subdivided Lot on a Plat other than Common Area.

"Majority" means more than 50%.

"Manager" has the meaning set forth in *Section 4.05(h)*.

"Members" means every person or entity that holds membership privileges in the Association.

"Mortgage" or **"Mortgages"** means any mortgage(s) or deed(s) of trust securing indebtedness and covering any Lot.

"Mortgagee" or **"Mortgagees"** means the holder(s) of any Mortgage(s).

"Owner" means the person(s), entity or entities, including Declarant, holding all or a portion of the fee simple interest in any Lot, but does not include the Mortgagee under a Mortgage prior to its acquisition of fee simple interest in such Lot pursuant to foreclosure of the lien of its Mortgage.

"Plat" means a subdivision plat of any portion of the Property as Recorded, and any amendments thereto.

"Property" means that certain tract of land located in Bexar County, Texas described on Exhibit "A" and further illustrated on the conceptual plan attached hereto as Exhibit "B", subject to such additions thereto and deletions therefrom as may be made pursuant to *Section 11.03* and *Section 11.04* of this Declaration.

"Rain Garden Facility" or **"Rain Garden Facilities"** means a vegetated, depressed landscape area and any related facilities within the Property designed to capture and infiltrate and/or filter storm water runoff.

"Record, Recording, Recordation and Recorded" means recorded or to be recorded in the Official Public Records of Bexar County, Texas.

"Resident" means an occupant or tenant of a Lot, regardless of whether the person owns the Lot.

"Restrictions" means the restrictions, covenants, and conditions contained in this Declaration, the Design Guidelines, Bylaws, Community Manual, Rules and Regulations, or in

any rules and regulations promulgated by the Association pursuant to this Declaration, as adopted and amended from time to time. See Table 1 for a summary of the Restrictions.

“Rules and Regulations” means any instrument, however denominated, which may be adopted by the Declarant as part of the Community Manual or subsequently adopted by the Board for the regulation and management of the Property, including any amendments to those instruments.

“Solar Energy Device” means a system or series of mechanisms designed primarily to provide heating or cooling or to produce electrical or mechanical power by collecting and transferring solar-generated energy. The term includes a mechanical or chemical device that has the ability to store solar-generated energy for use in heating or cooling or in the production of power.

TABLE 1: RESTRICTIONS	
Declaration (Recorded)	Creates obligations that are binding upon the Association and all present and future owners of Property.
Certificate of Formation (Recorded)	Establishes the Association as a Texas nonprofit corporation.
Bylaws (Recorded)	Governs the Association’s internal affairs, such as elections, meetings, etc.
Community Manual (Recorded)	Establishes rules and policies governing the Association.
Design Guidelines (if adopted, Recorded)	Governs the design and architectural standards for the construction of Improvements and modifications thereto.
Rules and Regulations (if adopted, Recorded)	Regulates the use of property, activities, and conduct within the Property.
Board Resolutions (adopted by the Board of the Association)	Establishes rules, policies, and procedures for the Association.

**ARTICLE 2
GENERAL AND USE RESTRICTIONS**

All of the Property shall be owned, held, encumbered, leased, used, occupied, and enjoyed subject to the following limitations and restrictions:

2.01 General.

(a) **Conditions and Restrictions.** All Lots within the Property will be owned, held, encumbered, leased, used, occupied and enjoyed subject to the Restrictions.

(b) **Ordinances.** Ordinances and requirements imposed by local governmental authorities are applicable to all Lots within the Property. Compliance with the Restrictions is not a substitute for compliance with such ordinances and regulations or any other Applicable Law.. Please be advised that the Restrictions do not purport to list or describe each restriction which may be applicable to a Lot located

within the Property. Each Owner is advised to review all ordinances, requirements, regulations and encumbrances affecting the use and improvement of their Lot prior to submitting plans to the ACC for approval. Furthermore, approval by the ACC should not be construed by the Owner that any Improvement complies with the terms and provisions of any ordinances, requirements, regulations or encumbrances which may affect the Owner's Lot. Certain encumbrances may benefit parties whose interests are not addressed by the ACC.

NOTICE

The Restrictions are subject to change from time to time. By owning or occupying a Lot, you agree to remain in compliance with the Restrictions, as they may change from time to time.

2.02 Conceptual Plans. All master plans, site plans, brochures, illustrations, information and marketing materials relating to the Property (collectively, the "Conceptual Plans") are conceptual in nature and are intended to be used for illustrative purposes only. The land uses and Improvements reflected on the Conceptual Plans are subject to change at any time and from time to time, and it is expressly agreed and understood that land uses within the Property may include uses which are not shown on the Conceptual Plans. Neither Declarant nor any Homebuilder or other developer of any portion of the Property makes any representation or warranty concerning such land uses and Improvements shown on the Conceptual Plans or otherwise planned for the Property and it is expressly agreed and understood that no Owner will be entitled to rely upon the Conceptual Plans in making the decision to purchase any land or Improvements within the Property. Each Owner who acquires a Lot within the Property acknowledges that development of the Property will likely extend over many years, and agrees that the Association will not engage in, or use Association funds to support, protest, challenge, or make any other form of objection to development of the Property or changes in the Conceptual Plans as they may be amended or modified from time to time.

2.03 Single-Family Residential Use. The Lots shall be used solely for private single family residential purposes and there shall not be constructed or maintained thereon more than one detached single family residence.

No professional, business, or commercial activity to which the general public is invited shall be conducted on any Lot, except an Owner or Resident may conduct business activities within a residence so long as: (i) such activity complies with all the applicable zoning ordinances; (ii) the business activity is conducted without the employment of persons other than the residents of the home constructed in the Lot; (iii) the existence or operation of the business activity is not apparent or detectable by sight, i.e., no sign may be erected advertising the business on any Lot, sound, or smell from outside the residence; (iv) the business activity conforms to all zoning requirements for the Property; (v) the business activity does not involve door-to-door solicitation of residents within the Property; (vi) the business does not, in the Board's judgment, generate a level of vehicular or pedestrian traffic or a number of vehicles parked within the Property which is noticeably greater than that which is typical of residences

in which no business activity is being conducted; (vii) the business activity is consistent with the residential character of the Property and does not constitute a nuisance, or a hazardous or offensive use, or threaten the security or safety of other residents of the Property as may be determined in the sole discretion of the Board; and (viii) the business does not require the installation of any machinery other than that customary to normal household operations. In addition, for the purpose of obtaining any business or commercial license, neither the residence or Lot will be considered open to the public. The terms "business" and "trade", as used in this provision, shall be construed to have their ordinary, generally accepted meanings and shall include, without limitation, any occupation, work, or activity undertaken on an ongoing basis which involves the provision of goods or services to persons other than the provider's family and for which the provider receives a fee, compensation, or other form of consideration, regardless of whether: (x) such activity is engaged in full or part-time; (y) such activity is intended to or does generate a profit; or (z) a license is required.

Leasing of a residence shall not be considered a business or trade within the meaning of this subsection. This subsection shall not apply to any activity conducted by the Declarant or a Homebuilder.

Notwithstanding any provision in this Declaration to the contrary, until the earlier to occur of expiration or termination of the Development Period, or forty (40) years from the date this Declaration is Recorded:

(i) Declarant and/or its licensees may construct and maintain upon portions of the Common Area and any Lot owned by the Declarant such facilities and may conduct such activities which, in Declarant's sole opinion, may be reasonably required, convenient, or incidental to the construction or sale of single family residences constructed upon the Lots, including, but not limited to, business offices, signs, model homes, and sales offices. Declarant and/or its licensees shall have an easement over and across the Common Area for access and use of such facilities at no charge; and

(ii) Declarant and/or its licensees will have an access easement over and across the Common Area for the purpose of making, constructing and installing Improvements to the Common Area.

2.04 Subdividing. No Lot shall be further divided or subdivided, nor may any easements or other interests therein less than the whole be conveyed by the Owner thereof without the prior written approval of the ACC; provided, however, that when Declarant is the Owner thereof, Declarant may further divide and subdivide any Lot and convey any easements or other interests less than the whole, all without the approval of the ACC. Notwithstanding the foregoing, a Homebuilder may plat Property owned by such Homebuilder in accordance with a plat approved by Declarant.

2.05 Hazardous Activities. No activities may be conducted on or within the Property and no Improvements constructed on any portion of the Property which, in the opinion of the Board, are or might be unsafe or hazardous to any person or property. Without limiting the generality of the foregoing, no firearms or fireworks may be discharged upon any portion of the Property unless discharged in conjunction with an event approved in advance by the Board and no open fires may be lighted or permitted except within safe and well-designed fireplaces or in contained barbecue units while attended and in use for cooking purposes. No portion of the Property may be used for the takeoff, storage, or landing of aircraft (including, without limitation, helicopters) except for medical emergencies.

2.06 Insurance Rates. Nothing shall be done or kept on the Property which would increase the rate of casualty or liability insurance or cause the cancellation of any such insurance on the Common Area, or the Improvements located thereon, without the prior written approval of the Board.

2.07 Mining and Drilling. No portion of the Property may be used for the purpose of mining, quarrying, drilling, boring, or exploring for or removing oil, gas, or other hydrocarbons, minerals of any kind, rocks, stones, sand, gravel, aggregate, or earth. This provision will not be construed to prevent the excavation of rocks, stones, sand, gravel, aggregate, or earth or the storage of such material for use as fill provided that such activities are conducted in conjunction with the construction of Improvements and/or the development of the Property by the Declarant. Furthermore, this provision will not be interpreted to prevent the drilling of water wells approved in advance by the ACC which are required to provide water to all or any portion of the Property. All water wells must also be approved in advance by any applicable regulatory authority.

2.08 Noise. No exterior speakers, horns, whistles, bells, or other sound devices (other than security devices used exclusively for security purposes and those sound devices permitted under *Section 2.09*) shall be located, used, or placed on any of the Property. No noise or other nuisance shall be permitted to exist or operate upon any portion of the Property so as to be offensive or detrimental to any other portion of the Property or to its Residents. Without limiting the generality of the foregoing, if any noise or nuisance emanates from any Improvement on any Lot, the Association may (but shall not be obligated to) enter any such Improvement and take such reasonable actions necessary to terminate such noise (including silencing any burglar or break-in alarm).

2.09 Outdoor Speakers. Outdoor speakers for residential entertainment purposes, including but not limited to, televisions, stereos, radios, computers, and surround sound systems, are permissible. If installed on a Lot, no outdoor speakers or other sound amplification devices, including but not limited to surround sound systems may be used on a Lot before 6:00 a.m. or after 10:00 p.m., CST. Owners shall comply with all applicable sound ordinances and Applicable Law.

2.10 Animals - Household Pets. No animals, including pigs, hogs, swine, poultry, fowl, wild animals, horses, cattle, sheep, goats, or any other type of animal not considered to be a domestic household pet within the ordinary meaning and interpretation of such words may be kept, maintained, or cared for on or within the Property (as used in this paragraph, the term "domestic household pet" shall not mean or include non-traditional pets such as pot-bellied pigs, miniature horses, exotic snakes or lizards, ferrets, monkeys or other exotic animals). The Board may conclusively determine, in its sole discretion, whether a particular pet is a domestic household pet within the ordinary meaning and interpretation of such words. No Owner may keep on such Owner's Lot more than four (4) cats and dogs, in the aggregate. No animal may be allowed to make an unreasonable amount of noise, or to become a nuisance, and no domestic pets will be allowed on the Property other than within the Owner's residence, or the fenced yard space associated therewith, unless confined to a leash. The Association may restrict pets to certain areas on the Property. No animal may be stabled, maintained, kept, cared for, or boarded for hire or remuneration on the Property, and no kennels or breeding operation will be allowed. No animal may be allowed to run at large, and all animals must be kept within enclosed areas which must be clean, sanitary, and reasonably free of refuse, insects, and waste at all times. No pet may be left unattended in yards, porches or other outside area, unless that area is enclosed with a fence. All pet waste will be removed and appropriately disposed of by the owner of the pet. All pets must be registered, licensed and inoculated as required by Applicable Law. If, in the opinion of the Board, any pet becomes a source of unreasonable annoyance to others, or the owner of the pet fails or refuses to comply with these restrictions, the Owner, upon written notice, may be required to remove the pet from the Property.

2.11 Rubbish and Debris. No rubbish or debris of any kind may be placed or permitted to accumulate on or within the Property, and no odors will be permitted to arise therefrom so as to render all or any portion of the Property unsanitary, unsightly, offensive, or detrimental to any other property or Residents. Refuse, garbage, and trash must be kept at all times in covered containers, and such containers must be kept within enclosed structures or appropriately screened from view. Each Owner will contract with an independent disposal service to collect all garbage or other wastes, if such service is not provided by a governmental entity or the Association. In the event the Owner shall fail or refuse to keep, or cause to be kept on such Owner's property or any improvements thereon free from rubbish or debris of any kind, and such failure or refusal shall continue for fifteen (15) days after delivery of written notice thereof, then the Association may (but not be obligated to) enter upon such property and remove or correct the same at the expense of the Owner and such entry shall not be deemed a trespass.

2.12 Maintenance. The Owners of each Lot shall jointly and severally have the duty and responsibility, at their sole cost and expense, to keep their Lot and all Improvements thereon in good condition and repair and in a well-maintained, safe, clean and attractive condition at all times. The Board, in its sole discretion, shall determine whether a violation of the maintenance obligations set forth in this *Section 2.12* has occurred. Such maintenance includes, but is not limited to the following, which shall be performed in a timely manner, as determined by the Board, in its sole discretion:

- (i) Prompt removal of all litter, trash, refuse, and wastes.
- (ii) Lawn mowing.
- (iii) Tree and shrub pruning.
- (iv) Watering.
- (v) Keeping exterior lighting and mechanical facilities in working order.
- (vi) Keeping lawn and garden areas alive, free of weeds, and attractive.
- (vii) Keeping planting beds free of turf grass.
- (viii) Keeping sidewalks and driveways in good repair.
- (ix) Complying with all government, health and police requirements.
- (x) Repainting of Improvements.
- (xi) Repair of exterior damage, and wear and tear to Improvements.

2.13 Antennas. Except as expressly provided below, no exterior radio or television antennae or aerial or satellite dish or disc, shall be erected, maintained or placed on a Lot without the prior written approval of the ACC; provided, however, that:

- (i) an antenna designed to receive direct broadcast services, including direct-to-home satellite services, that is one meter or less in diameter; or
- (ii) an antenna designed to receive video programming services via multipoint distribution services, including multi-channel multipoint distribution services, instructional television fixed services, and local multipoint distribution services, that is one meter or less in diameter or diagonal measurement; or
- (iii) an antenna that is designed to receive television or radio broadcast signals;
- (iv) (collectively, (i) through (iii) are referred to herein as the “Permitted Antennas”) will be permitted subject to reasonable requirements as to location and screening as may be set forth in rules adopted by the ACC, consistent with Applicable Law, in order to minimize obtrusiveness as viewed from streets and adjacent property. Declarant and/or the Association will have the right, but not the obligation, to erect an aerial, satellite dish, or other

apparatus for a master antenna, cable, or other communication system for the benefit of all or any portion of the Property.

(v) Original Homebuilders (Homebuilders who have purchased lots directly from Declarant), are permitted to install exterior antennas that are one meter or less in diameter on homes without the prior written approval of the ACC.

2.14 Location of Permitted Antennas. A Permitted Antenna may be installed solely on the Owner's Lot and shall not encroach upon any street, Common Area, or any other portion of the Property. A Permitted Antenna shall be installed in a location on the Lot from which an acceptable quality signal can be obtained and where least visible from the street and the Property, other than the Lot. In order of preference, the locations of a Permitted Antenna which will be considered least visible by the ACC are as follows:

(i) Attached to the back of the principal single-family residence constructed on the Lot, with no part of the Permitted Antenna any higher than the lowest point of the roofline and screened from view of adjacent Lots and the street; then

(ii) Attached to the side of the principal single-family residence constructed on the Lot, with no part of the Permitted Antenna any higher than the lowest point of the roofline and screened from view of adjacent Lots and the street.

The ACC may, from time to time, modify, amend, or supplement the rules regarding installation and placement of Permitted Antennas.

2.15 Signs. Unless otherwise prohibited by Applicable Law, no sign of any kind may be displayed to the public view on any Lot without the prior written approval of the ACC, except for:

(i) signs which are permitted pursuant to the Design Guidelines or rules adopted by the ACC;

(ii) signs which are part of Declarant or Homebuilder's overall marketing, sale, or construction plans or activities for the Property;

(iii) one (1) temporary "For Sale" or "For Lease" sign placed on the Lot. The sign will be limited to a maximum face area of five (5) square feet on each visible side and, if free standing, is mounted on a single or frame post. The overall height of the sign from finished grade at the spot where the sign is located may not exceed four (4) feet. The sign must be removed within five (5) business days following the sale or lease of the Lot;

(iv) candidate or measure signs may be erected provided the sign: (i) is erected no earlier than the 90th day before the date of the election to which the sign relates; (ii) is removed no later than the 10th day after the date of the election to which the sign relates; and (iii) is ground-mounted. Only one sign may be erected for each candidate or ballot item. In addition, signs which include any of the components or characteristics described in Section 259.002(d) of the Texas Election Code are prohibited;

(v) a religious item on the entry door or door frame of a residence (which may not extend beyond the outer edge of the door frame), provided that the size of the item(s), individually or in combination with other religious items on the entry door or door frame of the residence, does not exceed sixty (60) square inches;

(vi) permits as may be required by legal proceedings;

(vii) permits as may be required by any governmental entity; and

(viii) Temporary holiday signage (not to exceed a total of sixty square feet) is permitted for a time period not to exceed twenty-five days.

An Owner or resident will be permitted to post a "no soliciting" and "security warning" sign near or on the front door to their residence, provided, that the sign may not exceed twenty-five (25) square inches.

2.16 Flags – Approval Requirements. An Owner is permitted to display the flag of the United States of America, the flag of the State of Texas, an official or replica flag of any branch of the United States Military, or one (1) flag with official insignia of a college or university ("**Permitted Flag**") and permitted to install a flagpole no more than five feet (5') in length affixed to the front of a residence near the principal entry or affixed to the rear of a residence ("**Permitted Flagpole**"). Only two (2) Permitted Flagpoles are allowed per residence. A Permitted Flag or Permitted Flagpole need not be approved in advance by the ACC. Approval by the ACC is required prior to installing vertical freestanding flagpoles installed in the front or back yard area of any Lot ("**Freestanding Flagpole**").

2.17 Flags – Installation and Display. Unless otherwise approved in advance and in writing by the ACC, Permitted Flags, Permitted Flagpoles and Freestanding Flagpoles, installed in accordance with the Flagpole Application, must comply with the following:

(i) No more than one (1) Freestanding Flagpole OR no more than two (2) Permitted Flagpoles are permitted per Lot, on which only Permitted Flags may be displayed;

(ii) Any Permitted Flagpole must be no longer than five feet (5') in length and any Freestanding Flagpole must be no more than twenty feet (20') in height

(iii) Any Permitted Flag displayed on either a Permitted Flagpole or a Freestanding Flagpole may not be more than three feet in height by five feet in width (3'x5');

(iv) With the exception of flags displayed on Common Area or any Lot which is being used for marketing purposes by the Declarant or a Homebuilder, the flag of the United States of America must be displayed in accordance with 4 U.S.C. Sections 5-10 and the flag of the State of Texas must be displayed in accordance with Chapter 3100 of the Texas Government Code;

(v) The display of a Permitted Flag, or the location and construction of the Permitted Flagpole or a Freestanding Flagpole must comply with all Applicable Law, easements and setbacks of record;

(vi) Each Permitted Flagpole and Freestanding Flagpole must be constructed of permanent, long-lasting materials, with a finish appropriate to the materials used in the construction thereof and harmonious with the residence;

(vii) Any Permitted Flag, Permitted Flagpole, and Freestanding Flagpole must be maintained in good condition and any deteriorated Permitted Flag or deteriorated or structurally unsafe Permitted Flagpole or Freestanding Flagpole must be repaired, replaced or removed;

(viii) A Permitted Flag may be illuminated by no more than one (1) halogen landscaping light of low beam intensity which shall not be aimed towards or directly affect any neighboring Lot; and

(ix) Any external halyard of a Permitted Flagpole and Freestanding Flagpole must be secured so as to reduce or eliminate noise from flapping against the metal of the Permitted Flagpole and Freestanding Flagpole.

2.18 Tanks. The ACC must approve any tank used or proposed in connection with a single-family residential structure, including tanks for storage of fuel, water, oil, or liquid petroleum gas (LPG), and including swimming pool filter tanks. No elevated tanks of any kind may be erected, placed or permitted on any Lot without the advance written approval of the ACC. All permitted tanks must be screened from view in accordance with a screening plan approved in advance by the ACC. This provision will not apply to a tank used to operate a standard residential gas grill.

2.19 Temporary Structures. No tent, shack, or other temporary building, Improvement, or structure shall be placed upon the Property without the prior written approval

of the ACC; provided, however, that temporary structures necessary for storage of tools and equipment, and for office space for Homebuilder, architects and foremen during actual construction may be maintained with the prior approval of Declarant, approval to include the nature, size, duration, and location of such structure. Notwithstanding any provision in this Declaration to the contrary, an Owner shall be permitted, without ACC approval, to erect one (1) outbuilding on the Owner's Lot if: (i) the surface area of the pad on which the outbuilding is placed is less than or equal to eighty (80) square feet; (ii) the height of the outbuilding, measured from the surface of the Lot to the highest portion of the outbuilding is less than or equal to eight (8) feet; (iii) the outbuilding is constructed within an area completely enclosed by a privacy fence of not less than six (6) feet in height; (iv) the exterior of the outbuilding is constructed of the same or substantially similar materials and painted the same color as the principal residence structure constructed on the Lot, including the roof of the storage building; (v) the outbuilding is constructed within all applicable building setback lines; (vi) the outbuilding is not located on any easements as described and shown on the Plat and the survey for the Lot; and (vii) such buildings may not be used for habitation in any way. The ACC shall be entitled to determine, in its sole and absolute discretion, whether an outbuilding constructed on any Lot complies with the foregoing requirements.

2.20 Unightly Articles; Vehicles. No article deemed to be unsightly in the reasonable judgement of the ACC shall be permitted to remain on any Lot so as to be visible from adjoining property or from public or private thoroughfares. Without limiting the generality of the foregoing, trailers, graders, trucks other than pickups, boats, tractors, campers, wagons, buses, all-terrain vehicles and garden maintenance equipment shall be kept at all times except when in actual use, in enclosed structures or screened from view and no repair or maintenance work shall be done on any of the foregoing, or on any automobile (other than minor emergency repairs), except in enclosed garages or other structures. Service areas, storage areas, compost piles and facilities for hanging, drying or airing clothing or household fabrics shall be appropriately screened from view, and no lumber, grass, plant waste, shrub or tree clippings, metals, bulk materials, scrap, refuse or trash shall be kept, stored, or allowed to accumulate on any portion of the Property except within enclosed structures or appropriately screened from view. No: (i) racing vehicles; or (ii) other vehicles (including, without limitation, motorcycles or motor scooters) which are inoperable or do not have a current license tag shall be permitted to remain visible on any Lot or to be parked on any roadway within the Property.

No garage may be permanently enclosed or otherwise used for habitation unless approved in advance by the ACC.

2.21 Travel Trailers and Recreational Vehicles. No travel trailers or recreational vehicles shall be parked or placed on any Lot or used as a residence, either temporary or permanent, at any time. However, such vehicles may be parked temporarily for a period not to exceed forty-eight (48) consecutive hours during each **one (1)** month period.

2.22 Basketball Goals; Permanent and Portable. Permanent basketball goals are permitted in the front of the residence on a Lot provided the basketball goal is located

approximately twenty feet (20') from the street curb. Permanent basketball goals are not permitted in any street right-of-way. The basketball goal backboard must be perpendicular to the street and mounted on a black metal pole permanently installed in the ground. Portable basketball goals are permitted but must be stored in the rear of the Lot or inside garage from sundown to sunrise. Basketball goals must be properly maintained and painted, with the net in good repair.

2.23 Compliance with Restrictions. Each Owner, his or her family, Residents of a Lot, tenants, and the guests, invitees, and licensees of the preceding shall comply strictly with the provisions of the Restrictions as the same may be amended from time to time. Failure to comply with any of the Restrictions shall constitute a violation of the Restrictions and may result in a fine against the Owner in accordance with *Section 6.12* of this Declaration, and shall give rise to a cause of action to recover sums due for damages or injunctive relief, or both, maintainable by the Declarant, the Manager, the Board on behalf of the Association, the ACC, or by an aggrieved Owner. Without limiting any rights or powers of the Association, the Board may (but shall not be obligated to) remedy or attempt to remedy any violation of any of the provisions of Restrictions, and the Owner whose violation has been so remedied shall be personally liable to the Association for all costs and expenses of effecting (or attempting to effect) such remedy. If such Owner fails to pay such costs and expenses upon demand by the Association, such costs and expenses (plus interest from the date of demand until paid at the maximum lawful rate, or if there is no such maximum lawful rate, at the rate of one and one-half percent (1-1/2%) per month) shall be assessed against and chargeable to the Owner's Lot(s). Any such amounts assessed and chargeable against a Lot shall be secured by the liens reserved in this Declaration for Assessments and may be collected by any means provided in this Declaration for the collection of Assessments, including, but not limited to, foreclosure of such liens against the Owner's Lot(s). **Each such Owner shall indemnify and hold harmless the Association and its officers, directors, employees and agents from any cost, loss, damage, expense, liability, claim or cause of action incurred or that may arise by reason of the Association's acts or activities under this *Section 2.24* (including any cost, loss, damage, expense, liability, claim or cause of action arising out of the Association's negligence in connection therewith), except for such cost, loss, damage, expense, liability, claim or cause of action arising by reason of the Association's gross negligence or willful misconduct. "Gross negligence" as used herein does not include simple negligence, contributory negligence or similar negligence short of actual gross negligence.**

2.24 Liability of Owners for Damage to Common Area. No Owner shall in any way alter, modify, add to or otherwise perform any work upon the Common Area without the prior written approval of the Board. Each Owner shall be liable to the Association for any and all damages to: (i) the Common Area and any Improvements constructed thereon; or (ii) any Improvements constructed on any Lot, the maintenance of which has been assumed by the Association, which damages were caused by the neglect, misuse or negligence of such Owner or Owner's family, or by any tenant or other Resident of such Owner's Lot, or any guest or invitee of such Owner. The full cost of all repairs of such damage shall be an assessment against such

Owner's Lot, secured by a lien against such Owner's Lot and collectable in the same manner as provided in *Section 6.10* of this Declaration.

2.25 No Warranty of Enforceability. Declarant makes no warranty or representation as to the present or future validity or enforceability of the Restrictions. Any Owner acquiring a Lot in reliance on one or more of the Restrictions shall assume all risks of the validity and enforceability thereof and, by acquiring the Lot, agrees to hold Declarant harmless therefrom.

2.26 Party Wall Fences. A fence or wall located on or near the dividing line between two (2) Lots and intended to benefit both Lots constitutes a "Party Wall" and, to the extent not inconsistent with the provisions of this *Section 2.27*, is subject to the general rules of law regarding party walls and liability for property damage due to negligence, willful acts, or omissions.

(a) **Encroachments & Easement.** If the Party Wall is on one Lot due to an error in construction, the Party Wall is nevertheless deemed to be on the dividing line for purposes of this *Section 2.27*. Each Lot sharing a Party Wall is subject to an easement for the existence and continuance of any encroachment by the Party Wall as a result of construction, repair, shifting, settlement, or movement in any portion of the Party Wall, so that the encroachment may remain undisturbed as long as the Party Wall stands. Each Lot is subject to a reciprocal easement for the maintenance, repair, replacement, or reconstruction of the Party Wall.

(b) **Right to Repair.** If the Party Wall is damaged or destroyed from any cause, the Owner of either Lot may repair or rebuild the Party Wall to its previous condition, and the Owners of both Lots, their successors and assigns, have the right to the full use of the repaired or rebuilt Party Wall.

(c) **Maintenance Costs.** The Owners of the adjoining Lots share equally the costs of repair, reconstruction, or replacement of the Party Wall, subject to the right of one Owner to call for larger contribution from the other under any rule of law regarding liability for negligence or willful acts or omissions. If an Owner is responsible for damage to or destruction of the Party Wall, that Owner will bear the entire cost of repair, reconstruction, or replacement. If an Owner fails or refuses to pay his share of costs of repair or replacement of the Party Wall, the Owner advancing monies has a right to file a claim of lien for the monies advanced in the Official Public Records of Hays County, Texas, and has the right to foreclose the lien as if it were a mechanic's lien. The right of an Owner to require contribution from another Owner under this Section is appurtenant to the Lot and passes to the Owner's successors in title.

(d) **Alterations.** The Owner of a Lot sharing a Party Wall may not cut openings in the Party Wall or alter or change the Party Wall in any manner that affects the use, condition, or appearance of the Party Wall to the adjoining Lot. The Party Wall

will always remain in the same location as when erected unless otherwise approved by the Owner of each Lot sharing the Party Wall and the ACC.

2.27 Lift Station, Drainage Facilities, Rain Garden Facilities, Drainage Pond. The Property includes a lift station and may include, now or in the future, one or more water drainage and detention facilities, Rain Garden Facilities, or ponds, including but not limited to pipes, inlets, controls, diverters, walls, and channels, which serve all or a portion of the Property (the "**Utility Facilities**"). The Utility Facilities will be maintained by the Association or its assignee in good condition and repair and in accordance with Applicable Law. Access to the Utility Facilities is limited to Persons engaged by the Association to periodically maintain such facilities. Each Owner is advised that the Utility Facilities are an active utility feature integral to the proper operation of the Property and that entry thereon may result in injury. The Utility Facilities, if any, are hereby designated as Common Area.

2.28 Release. EACH OWNER HEREBY RELEASES AND HOLDS HARMLESS THE ASSOCIATION, DECLARANT, THE BOARD, THE HOMEBUILDERS AND THEIR AFFILIATES, OFFICERS, DIRECTORS, COMMITTEE MEMBERS, EMPLOYEES AND AGENTS FROM ANY COST, LOSS, DAMAGE, EXPENSE, LIABILITY, CLAIM OR CAUSE OF ACTION INCURRED OR THAT MAY ARISE BY REASON OF SUCH OWNER'S USE OF ANY COMMON AREA. Neither the Association nor Declarant shall assume any responsibility or liability for any personal injury or property damage which is occasioned by use of any Common Area, and in no circumstance shall words or actions by the Association or Declarant constitute an implied or express representation or warranty regarding the fitness or condition of any Common Area.

2.29 No Warranty of Enforceability. Declarant makes no warranty or representation as to the present or future validity or enforceability of the Restrictions. Any Owner acquiring a Lot in reliance on one or more of the Restrictions shall assume all risks of the validity and enforceability thereof and, by acquiring the Lot, agrees to hold Declarant and Homebuilders harmless therefrom.

ARTICLE 3 CONSTRUCTION RESTRICTIONS

3.01 Approval for Construction. Unless prosecuted by the Declarant, no Improvements shall be constructed upon any Lot without the prior written approval of the ACC in accordance with Article 7 of this Declaration.

3.02 Rentals. Nothing in this Declaration shall prevent the rental of any Lot and the Improvements thereon by the Owner thereof for residential purposes; provided that all rentals must be for terms of at least six (6) months. All leases shall be in writing. The Owner must provide to its lessee copies of the Restrictions. Notice of any lease, together with such additional information as may be required by the Board, will be remitted to the Association by the Owner on or before the expiration of ten (10) days after the effective date of the lease.

3.03 **Garages.** No garage may be permanently enclosed or otherwise used for habitation.

3.04 **Fences; Sidewalks.** The design, construction materials, height and location of all other fences, not installed by Declarant or original Homebuilder, shall otherwise be approved by the ACC. Unless constructed by the original builder, no fence or wall may be erected, placed or altered on a lot nearer to the front street than the front wall of the single family dwelling which is located on the Lot and no hedge may be installed or maintained more than three (3) feet in front of the wall of the single family dwelling which is located on the Lot and closest to the front property line of the Lot. Construction of gates or other access openings in the perimeter of the Property, other than installed by the original builder, shall not be allowed on any Lot without prior written consent by the ACC.

3.05 **Driveways.** No painted or sealed driveways are permitted. All driveways must be constructed in accordance with any Plat requirements and Applicable Law..

3.06 **Dwelling Size; Building Materials.** All residences shall contain not less than 1,100 square feet of enclosed living space, exclusive of porches (open or covered), decks, garages, and carports. All building material must be approved in advance by the ACC, and only new building materials (except for used brick) may be used for construction of any Improvements. Exposed metal roof decks which reflect light in a glaring manner such as galvanized steel sheets are specifically prohibited in all manners except when used as a decorative architectural feature on awnings or porch roofs. Other roofing materials may be used with the prior written consent of the ACC, which may specify a minimum quality or grade of materials. All projections from a dwelling or other structure, including but not limited to chimney flues, vents, gutters, downspouts, utility boxes, porches, railings and exterior stairways must match the color of the surface from which they project, or shall be of a color specified by the original builder, or as approved by the ACC. No highly reflective finishes (other than glass, which may not be mirrored) may be used on exterior surfaces (other than surfaces of hardware fixtures), including, without limitation, the exterior surfaces of any Improvements.

The masonry requirements for single and two-story dwellings shall be as follows:

Single-Family Dwellings. All homes located within 300 linear feet of Hickory Ridge Blvd. shall have the following masonry restriction: the front façade shall contain no less than 35% masonry (stone, brick or stucco), exclusive of roofs, eaves, soffits, windows, doors, gables, garage doors and trim and decorative work. The exterior side walls and rear wall have no masonry requirement. For avoidance of doubt, all homes located outside of the 300-foot Hickory Ridge Blvd. buffer shall not have a masonry restriction.

3.07 **Alteration or Removal of Improvements.** Any construction, other than normal maintenance, which in any way alters the exterior appearance of any Improvement, or the removal of any Improvement shall be performed only with the prior written approval of the ACC.

3.08 **Trash Containers.** Trash containers and recycling bins must be stored in one of the following locations:

- (a) inside the garage of the single-family residence constructed on the Lot; or
- (b) behind the single-family residence or fence constructed on the Lot in such a manner that the trash container and recycling bin is not visible from any street, alley, or adjacent Lot.

The Board shall have the right to specify additional locations on each Owner's Lot in which trash containers or recycling bins must be stored.

3.09 **Drainage.** There shall be no interference with the established drainage patterns over any of the Property, including the Lots, except by Declarant, unless adequate provision is made for proper drainage and such provision is approved in advance by the ACC. Specifically, and not by way of limitation, no Improvement, including but without limitation, landscaping or gardens, may be installed within any dedicated drainage channel or detention pond, as reflected on the Plat, or which impedes the proper drainage of water between Lots.

3.10 **Construction Activities.** This Declaration will not be construed or applied so as to unreasonably interfere with or prevent normal construction activities during the construction of Improvements by an Owner (including Declarant or a Homebuilder) upon or within the Property. Specifically, no such construction activities will be deemed to constitute a nuisance or a violation of this Declaration by reason of noise, dust, presence of vehicles or construction machinery, posting of signs or similar activities, provided that such construction is pursued to completion with reasonable diligence and conforms to usual construction practices in the area. In the event that construction upon any Lot does not conform to usual practices in the area as determined by the ACC in its sole and reasonable judgment, the ACC will have the authority to seek an injunction to stop such construction. In addition, if during the course of construction upon any Lot there is excessive accumulation of debris of any kind which would render the Lot or any portion thereof unsanitary, unsightly, offensive, or detrimental to it or any other portion of the Property, then the ACC may contract for or cause such debris to be removed, and the Owner of the Lot will be liable for all reasonable expenses incurred in connection therewith.

3.11 **Roofing.** All roofing material shall be permitted only with the advance written approval of the ACC. In addition, roofs of buildings may be constructed with "Energy Efficiency Roofing" with the advance written approval of the ACC. For the purpose of this Section, "Energy Efficiency Roofing" means shingles that are designed primarily to: (a) be wind and hail resistant; (b) provide heating and cooling efficiencies greater than those provided by customary

composite shingles; or (c) provide solar generation capabilities. The ACC will not prohibit an Owner from installing Energy Efficient Roofing provided that the Energy Efficient Roofing shingles: (i) resemble the shingles used or otherwise authorized for use within the community; (ii) are more durable than, and are of equal or superior quality to, the shingles used or otherwise authorized for use within the community; and (iii) match the aesthetics of adjacent property. An Owner who desires to install Energy Efficient Roofing will be required to comply with the architectural review and approval procedures set forth the Restrictions. In conjunction with any such approval process, the Owner should submit information which will enable the ACC to confirm the criteria set forth in this Section. Any other type of roofing material shall be permitted only with the advance written approval of the ACC.

3.12 Swimming Pools. Any swimming pool constructed on a Lot must be enclosed with a fence or other enclosure device completely surrounding the swimming pool which, at a minimum, satisfies all applicable governmental requirements and be approved in advance by the ACC. Nothing in this *Section 3.12* is intended or shall be construed to limit or affect an Owner's obligation to comply with any applicable governmental regulations concerning swimming pool enclosure requirements. Unless otherwise approved in advance by the ACC, above-ground or temporary swimming pools are not permitted on a Lot.

3.13 Compliance with Setbacks. No residence may be constructed on any Lot nearer to a street than the minimum building setback lines shown on the Plat containing such Lot. No building shall be located on any utility easements and other applicable easements as depicted on the Plat.

3.14 Solar Energy Device. Solar Energy Devices may be installed with the advance written approval of the ACC in accordance with the procedures set forth below.

(a) Application. To obtain ACC approval of a Solar Energy Device, the Owner shall provide the ACC with the following information: (i) the proposed installation location of the Solar Energy Device; and (ii) a description of the Solar Energy Device, including the dimensions, manufacturer, and photograph or other accurate depiction (the "**Solar Application**"). A Solar Application may only be submitted by an Owner unless the Owner's tenant provides written confirmation at the time of submission that the Owner consents to the Solar Application. The Solar Application shall be submitted in accordance with the provisions of *Article 7* of the Declaration.

(b) Approval Process. The ACC will review the Solar Application in accordance with the terms and provisions of *Article 7* of the Declaration. The ACC will approve a Solar Energy Device if the Solar Application complies with *Section 3.14(c)* below UNLESS the ACC makes a written determination that placement of the Solar Energy Device, despite compliance with *Section 3.14(c)*, will create a condition that substantially interferes with the use and enjoyment of the property within the Property by causing unreasonable discomfort or annoyance to persons of ordinary sensibilities. The ACC's right to make a written determination in accordance with the foregoing

sentence is negated if all Owners of Lots immediately adjacent to the Owner/applicant provide written approval of the proposed placement. Any proposal to install a Solar Energy Device on Common Area or property maintained by the Association must be approved in advance and in writing by the Board, and the Board need not adhere to this Section when considering any such request.

(c) Approval Conditions. Unless otherwise approved in advance and in writing by the ACC, each Solar Application and each Solar Energy Device to be installed in accordance therewith must comply with the following:

(i) The Solar Energy Device must be located on the roof of the residence located on the Owner's Lot, entirely within a fenced area of the Owner's Lot, or entirely within a fenced patio located on the Owner's Lot. If the Solar Energy Device will be located on the roof of the residence, the ACC may designate the location for placement unless the location proposed by the Owner increases the estimated annual energy production of the Solar Energy Device, as determined by using a publicly available modeling tool provided by the National Renewable Energy Laboratory, by more than 10 percent above the energy production of the Solar Energy Device if installed in the location designated by the ACC. If the Owner desires to contest the alternate location proposed by the ACC, the Owner should submit information to the ACC which demonstrates that the Owner's proposed location meets the foregoing criteria. If the Solar Energy Device will be located in the fenced area of the Owner's Lot or patio, no portion of the Solar Energy Device may extend above the fence line.

(ii) If the Solar Energy Device is mounted on the roof of the principal residence located on the Owner's Lot, then: (A) the Solar Energy Device may not extend higher than or beyond the roofline; (B) the Solar Energy Device must conform to the slope of the roof and the top edge of the Solar Device must be parallel to the roofline; (C) the frame, support brackets, or visible piping or wiring associated with the Solar Energy Device must be silver, bronze or black.

3.15 Rainwater Harvesting Systems. Rain barrels or rainwater harvesting systems (a "Rainwater Harvesting System") may be installed with the advance written approval of the ACC.

(a) Application. To obtain ACC approval of a Rainwater Harvesting System, the Owner shall provide the ACC with the following information: (i) the proposed installation location of the Rainwater Harvesting System; and (ii) a description of the Rainwater Harvesting System, including the color, dimensions, manufacturer, and photograph or other accurate depiction (the "Rain System Application"). A Rain System Application may only be submitted by an Owner unless the Owner's tenant provides written confirmation at the time of submission that the Owner consents to the Rain System Application.

(b) Approval Process. The decision of the ACC will be made in accordance with Article 7 of the Declaration. Any proposal to install a Rainwater Harvesting System on Common Area must be approved in advance and in writing by the Board, and the Board need not adhere to this Section when considering any such request.

(c) Approval Conditions. Unless otherwise approved in advance and in writing by the ACC, each Rain System Application and each Rainwater Harvesting System to be installed in accordance therewith must comply with the following:

(i) The Rainwater Harvesting System must be consistent with the color scheme of the residence constructed on the Owner's Lot, as reasonably determined by the ACC.

(ii) The Rainwater Harvesting System does not include any language or other content that is not typically displayed on such a device.

(iii) The Rainwater Harvesting System is in no event located between the front of the residence constructed on the Owner's Lot and any adjoining or adjacent street.

(iv) There is sufficient area on the Owner's Lot to install the Rainwater Harvesting System, as reasonably determined by the ACC.

(v) If the Rainwater Harvesting System will be installed on or within the side yard of a Lot, or would otherwise be visible from a street, common area, or another Owner's Lot, the ACC may regulate the size, type, shielding of, and materials used in the construction of the Rainwater Harvesting System. See *Section 3.15(d)* for additional guidance.

(d) Guidelines. If the Rainwater Harvesting System will be installed on or within the side yard of a Lot, or would otherwise be visible from a street, Common Area, or another Owner's Lot, the ACC may regulate the size, type, shielding of, and materials used in the construction of the Rainwater Harvesting System. Accordingly, when submitting a Rain System Application, the application should describe methods proposed by the Owner to shield the Rainwater Harvesting System from the view of any street, Common Area, or another Owner's Lot. When reviewing a Rain System Application for a Rainwater Harvesting System that will be installed on or within the side yard of a Lot, or would otherwise be visible from a street, Common Area, or another Owner's Lot, any additional regulations imposed by the ACC to regulate the size, type, shielding of, and materials used in the construction of the Rainwater Harvesting System, may not prohibit the economic installation of the Rainwater Harvesting System, as reasonably determined by the ACC.

3.16 Landscaping; Xeriscaping. As part of the installation and maintenance of landscaping on an Owner's Lot, an Owner may submit plans for and install drought tolerant

landscaping (“Xeriscaping”) upon written approval by the ACC. Any Homebuilder that purchases a Lot directly from Declarant will not be required to submit landscaping plans to the ACC. Notwithstanding the foregoing or anything herein to the contrary, each Lot must have at least two (2) trees of no less than 2” in caliper at issuance of certificate of occupancy. All Owners implementing Xeriscaping shall comply with the following:

(a) Application. Approval by the ACC is required prior to installing Xeriscaping. To obtain the approval of the ACC for Xeriscaping, the Owner shall provide the ACC with the following information: (i) the proposed site location of the Xeriscaping on the Owner’s Lot; (ii) a description of the Xeriscaping, including the types of plants, border materials, hardscape materials and photograph or other accurate depiction and (iii) the percentage of yard to be covered with gravel, rocks and cacti (the “**Xeriscaping Application**”). A Xeriscaping Application may only be submitted by an Owner unless the Owner’s tenant provides written confirmation at the time of submission that the Owner consents to the Xeriscaping Application. The ACC is not responsible for: (A) errors or omissions in the Xeriscaping Application submitted to the ACC for approval; (B) supervising installation or construction to confirm compliance with an approved Xeriscaping Application or (C) the compliance of an approved application with Applicable Law.

(b) Approval Conditions. Unless otherwise approved in advance and in writing by the ACC, each Xeriscaping Application and all Xeriscaping to be installed in accordance therewith must comply with the following:

(i) No Owners shall install gravel, rocks or cacti that in the aggregate encompass over thirty percent (30%) of such Owner’s front yard.

(ii) The Xeriscaping must not attract diseases and insects that are harmful to the existing landscaping on neighboring Lots, as reasonably determined by the ACC.

(c) Process. The decision of the ACC will be made within a reasonable time, or within the time period otherwise required by the principal deed restrictions which govern the review and approval of improvements. A Xeriscaping Application submitted to install Xeriscaping on property owned by the Association or property owned in common by members of the Association will not be approved. Any proposal to install Xeriscaping on property owned by the Association or property owned in common by members of the Association must be approved in advance and in writing by the Board, and the Board need not adhere to the requirements set forth in this *Section 3.16* when considering any such request.

(d) Approval. Each Owner is advised that if the Xeriscaping Application is approved by the ACC, installation of the Xeriscaping must: (i) strictly comply with the Xeriscaping Application; (ii) commence within sixty (60) days of approval; and (iii) be

time frame diligently prosecuted to completion. If the Owner fails to cause the Xeriscaping to be installed in accordance with the approved Xeriscaping Application, the ACC may require the Owner to: (A) modify the Xeriscaping Application to accurately reflect the Xeriscaping installed on the Property; or (B) remove the Xeriscaping and reinstall the Xeriscaping in accordance with the approved Xeriscaping Application. Failure to install Xeriscaping in accordance with the approved Xeriscaping Application or an Owner's failure to comply with the post-approval requirements constitutes a violation of this Declaration and may subject the Owner to fines and penalties. Any requirement imposed by the ACC to resubmit a Xeriscaping Application or remove and relocate Xeriscaping in accordance with the approved Xeriscaping Application shall be at the Owner's sole cost and expense.

ARTICLE 4

ELMENDORF HICKORY RIDGE COMMUNITY ASSOCIATION, INC.

4.01 Organization. The Association will be a nonprofit corporation created for the purposes, charged with the duties, and vested with the powers of a Texas non-profit corporation. Neither the Certificate nor Bylaws will for any reason be amended or otherwise changed or interpreted so as to be inconsistent with this Declaration.

4.02 Membership.

(a) Mandatory Membership. Any person or entity, upon becoming an Owner, will automatically become a Member of the Association. Membership will be appurtenant to and will run with the ownership of the Lot that qualifies the Owner thereof for membership, and membership may not be severed from the ownership of the Lot, or in any way transferred, pledged, mortgaged or alienated, except together with the title to such Lot.

<p>If you acquire a Lot you automatically become a member of the Association. Membership is Mandatory!</p>

(b) Easement of Enjoyment – Common Area. Every Member will have a right and easement of enjoyment in and to all of the Common Area and an access easement by and through any Common Area, which easements will be appurtenant to and will pass with the title to such Member's Lot, subject to the following restrictions and reservations:

(i) The right of the Declarant to cause such Improvements and features to be constructed upon the Common Area, as determined from time to time by the Declarant, in the Declarant's sole and absolute discretion;

(ii) The right of the Association to suspend the Member's right to use the Common Area for any period during which any Assessment against such

Member's Lot remains past due and for any period during which such member is in violation of any provision of this Declaration;

(iii) The right of the Declarant (during the Development Period) and the Board thereafter to dedicate or transfer all or any part of the Common Area to any public agency, authority or utility for any purpose;

(iv) The right of the Declarant (during the Development Period) and the Board thereafter to grant easements or licenses over and across the Common Area;

(v) With the advance written approval of the Declarant during the Development Period, the right of the Board to borrow money for the purpose of improving the Common Area and, in furtherance thereof, mortgage the Common Area;

(vi) The right of the Declarant, during the Development Period, and the Board, with the advance written approval of the Declarant during the Development Period, to promulgate Rules and Regulations regarding the use of the Common Area and any Improvements thereon; and

(vii) The right of the Association to contract for services with any third parties on such terms as the Board may determine, except that during the Development Period, all such contracts must be approved in advance and in writing by the Declarant.

4.03 Governance. The Board will consist of at least three (3) Persons elected at the annual meeting of the Association, or at a special meeting called for such purpose. **Notwithstanding the foregoing provision or any provision in this Declaration to the contrary, Declarant will have the sole right to appoint and remove all members of the Board until the 10th anniversary of the date this Declaration is Recorded. Not later than the 10th anniversary of the date this Declaration is Recorded, or sooner as determined by Declarant, the Board will call a meeting of Members of the Association for the purpose of electing one-third of the Board (the "Initial Member Election Meeting"), which Board member(s) must be elected by Owners other than the Declarant. Declarant shall continue to have the sole right to appoint and remove two-thirds of the Board from and after the Initial Member Election Meeting until expiration or termination of the Development Period.**

4.04 Voting Rights. The right to cast votes and the number of votes which may be cast for election of members to the Board (except as provided by *Section 4.03*) and on all other matters to be voted on by the Members will be calculated as set forth below.

(a) The Owner of each Lot will have one (1) vote for each Lot so owned.

(b) In addition to the votes to which Declarant is entitled by reason of *Section 4.04(a)*, for every one (1) vote outstanding in favor of any other person or entity, Declarant will have four (4) additional votes until the expiration or termination of the Development Period.

(c) When more than one person or entity owns a portion of the fee simple interest in any Lot, all such persons or entities will be Members. The vote or votes (or fraction thereof) for such Lot will be exercised by the person so designated in writing to the Secretary of the Association by the Owner of such Lot, and in no event will the vote for such Lot exceed the total votes to which such Lot is otherwise entitled under this *Section 4.04*.

4.05 Powers. The Association will have the powers of a Texas nonprofit corporation. It will further have the power to do and perform any and all acts that may be necessary or proper, for or incidental to, the exercise of any of the express powers granted to it by the laws of Texas or this Declaration. Without in any way limiting the generality of the two preceding sentences, the Board, acting on behalf of the Association, will have the following powers at all times:

(a) Rules, Bylaws and Community Manual. To make, establish and promulgate, and in its discretion to amend from time to time, or repeal and re-enact, such rules, regulations, Bylaws and Community Manual not in conflict with this Declaration, as it deems proper, covering any and all aspects of the Property (including the operation, maintenance and preservation thereof) or the Association. Any Rules and Regulations, and any modifications to existing Rules and Regulations, or the Bylaws proposed by the Board must be approved in advance and in writing by the Declarant until expiration or termination of the Development Period.

(b) Insurance. To obtain and maintain in effect, policies of insurance that, in the opinion of the Board, are reasonably necessary or appropriate to carry out the Association's functions.

(c) Records. To keep books and records of the Association's affairs, and to make such books and records, together with current copies of the Restrictions available for inspection by the Owners, Mortgagees, and insurers or guarantors of any Mortgage upon request during normal business hours.

(d) Assessments. To levy and collect assessments, as provided in *Article 6* below.

(e) Right of Entry and Enforcement. To enter at any time without notice in an emergency (or in the case of a non-emergency, after twenty-four (24) hours written notice), without being liable to any Owner or Resident, upon any Lot and into any Improvement thereon for the purpose of enforcing the Restrictions or for the purpose of

maintaining or repairing any area, Improvement or other facility to conform to the Restrictions. The expense incurred by the Association in connection with the entry upon any Lot and the maintenance and repair work conducted thereon or therein will be a personal obligation of the Owner of the Lot so entered, will be deemed an Individual Assessment against such Lot, will be secured by a lien upon such Lot, and will be enforced in the same manner and to the same extent as provided in *Article 6* hereof for Assessments. The Association will have the power and authority from time to time, in its own name and on its own behalf, or in the name of and on behalf of any Owner who consents thereto, to commence and maintain actions and suits to enforce, by mandatory injunction or otherwise, or to restrain and enjoin, any breach or threatened breach of the Restrictions. The Association is also authorized to settle claims, enforce liens and take all such action as it may deem necessary or expedient to enforce the Restrictions; provided, however, that the Board will never be authorized to expend any Association funds for the purpose of bringing suit against Declarant, a Homebuilder, or their successors or assigns. The Association may not alter or demolish any Improvements on any Lot other than Common Area in enforcing these Restrictions before a judicial order authorizing such action has been obtained by the Association, or before the written consent of the Owner(s) of the affected Lot(s) has been obtained. **EACH SUCH OWNER AND RESIDENT WILL INDEMNIFY AND HOLD HARMLESS THE ASSOCIATION, ITS OFFICERS, DIRECTORS, EMPLOYEES AND AGENTS FROM ANY COST, LOSS, DAMAGE, EXPENSE, LIABILITY, CLAIM OR CAUSE OF ACTION INCURRED OR THAT MAY ARISE BY REASON OF THE ASSOCIATION'S ACTS OR ACTIVITIES UNDER THIS SECTION 4.05(e) (INCLUDING ANY COST, EXPENSE, LIABILITY, CLAIM OR CAUSE OF ACTION ARISING OUT OF THE ASSOCIATION'S NEGLIGENCE IN CONNECTION THEREWITH), EXCEPT FOR SUCH COST, LOSS, DAMAGE, EXPENSE, LIABILITY, CLAIM OR CAUSE OF ACTION ARISING BY REASON OF THE ASSOCIATION'S GROSS NEGLIGENCE OR WILLFUL MISCONDUCT. "GROSS NEGLIGENCE" DOES NOT INCLUDE SIMPLE NEGLIGENCE, CONTRIBUTORY NEGLIGENCE OR SIMILAR NEGLIGENCE SHORT OF ACTUAL GROSS NEGLIGENCE.**

(f) Legal and Accounting Services. To retain and pay for legal and accounting services necessary or proper in the operation of the Association.

(g) Conveyances. To grant and convey to any person or entity the real property and/or other interest, including fee title, leasehold estates, easements, rights-of-way or mortgages, out of, in, on, over, or under any Common Area for the purpose of constructing, erecting, operating or maintaining the following:

- (i) Parks, parkways or other recreational facilities or structures;
- (ii) Roads, streets, sidewalks, signs, street lights, walks, driveways, trails and paths;

- (iii) Lines, cables, wires, conduits, pipelines or other devices for utility purposes;
- (iv) Sewers, water systems, storm water drainage systems, sprinkler systems and pipelines; and/or
- (v) Any similar Improvements or facilities.

Nothing set forth above, however, will be construed to permit use or occupancy of any Improvement or other facility in a way that would violate applicable use and occupancy restrictions imposed by the Restrictions or by any Applicable Law. In addition, until expiration or termination of the Development Period, any grant or conveyance under this *Section 4.05(g)* must be approved in advance and in writing by the Declarant.

(h) Manager. To retain and pay for the services of a person or firm (the "**Manager**"), which may include Declarant or any affiliate of Declarant, to manage and operate the Association, including its property, to the extent deemed advisable by the Board. Personnel may be employed directly by the Association or may be furnished by the Manager. Each contract entered into between the Association and the Manager will be terminable by the Association without cause upon sixty (60) days written notice to the Manager. To the extent permitted by law, the Board may delegate any other duties, powers and functions to the Manager. In addition, the Board may adopt reasonable transfer fees, resale certificate fees or any other fees associated with the provision of management services to the Association or its Members. **THE MEMBERS HEREBY RELEASE THE ASSOCIATION AND THE MEMBERS OF THE BOARD AND COMMITTEE MEMBERS FROM LIABILITY FOR ANY OMISSION OR IMPROPER EXERCISE BY THE MANAGER OF ANY SUCH DUTY, POWER OR FUNCTION SO DELEGATED.**

(i) Property Services. To pay for water, sewer, garbage removal, street lights, landscaping, gardening and all other utilities, services, repair and maintenance for any portion of the Property, Common Area, private or public recreational facilities, easements, roads, roadways, rights-of-ways, signs, parks, parkways, median strips, sidewalks, paths, trails, ponds, and lakes.

(j) Other Services and Properties. To obtain and pay for any other property and services, and to pay any other taxes or assessments that the Association or the Board is required or permitted to secure or to pay for pursuant to Applicable Law or under the terms of the Restrictions or as determined by the Board.

(k) Construction on Common Area. To construct new Improvements or additions to any property owned, leased, or licensed by the Association, subject to the

approval of the Board and the Declarant until expiration or termination of the Development Period.

(l) Contracts. To enter into Bulk Rate Contracts or other contracts or licenses with Declarant or any third party on such terms and provisions as the Board will determine, to operate and maintain any Common Area or other property, or to provide any service, including but not limited to cable, utility, or telecommunication services, or perform any function on behalf of Declarant, the Board, the Association, or the Members. During the Development Period, all Bulk Rate Contracts must be approved in advance and in writing by the Declarant.

(m) Property Ownership. To acquire, own and dispose of all manner of real and personal property, including habitat, whether by grant, lease, easement, gift or otherwise. During the Development Period, all acquisitions and dispositions of the Association hereunder must be approved in advance and in writing by the Declarant.

(n) Allocation of Votes. To determine votes when permitted pursuant to Section 4.04 above.

(o) Membership Privileges. To establish rules and regulations governing and limiting the use of the Common Area and any Improvements thereon.

4.06 Acceptance of Common Area. The Association may acquire, hold, and dispose of any interest in tangible and intangible personal property and real property. The Declarant and its assignees and a Homebuilder may transfer or convey to the Association interests in real or personal property owned by such Declarant for the benefit of the Property, or the Property and the general public, and the Association will reasonably accept such transfers and conveyances. Such property may be improved or unimproved and may consist of fee simple title, easements, leases, licenses, or other real or personal property interests. If accepted by the Association in its reasonable discretion, the property thereafter will be maintained as Common Area by the Association for the benefit of the Property and/or the general public subject to any restrictions set forth in the deed or other instrument transferring or assigning such property to the Association. Upon Declarant's or a Homebuilder's written request, the Association will re-convey to the requesting Declarant or Homebuilder (with reasonable approval by the Declarant) any unimproved real property that the Declarant or requesting Homebuilder originally conveyed to the Association for no payment to the extent conveyed in error or needed to make minor adjustments in property lines, as determined in the reasonable discretion of the Declarant or Homebuilder, as applicable.

4.07 Indemnification. TO THE FULLEST EXTENT PERMITTED BY APPLICABLE LAW BUT WITHOUT DUPLICATION (AND SUBJECT TO) ANY RIGHTS OR BENEFITS ARISING UNDER THE CERTIFICATE OR BYLAWS OF THE ASSOCIATION, THE ASSOCIATION WILL INDEMNIFY ANY PERSON WHO WAS, OR IS, A PARTY, OR IS THREATENED TO BE MADE A PARTY TO ANY THREATENED PENDING OR

COMPLETED ACTION, SUIT OR PROCEEDING, WHETHER CIVIL, CRIMINAL, ADMINISTRATIVE OR INVESTIGATIVE BY REASON OF THE FACT THAT HE IS, OR WAS, A DIRECTOR, OFFICER, COMMITTEE MEMBER, EMPLOYEE, SERVANT OR AGENT OF THE ASSOCIATION AGAINST EXPENSES, INCLUDING ATTORNEYS' FEES, REASONABLY INCURRED BY HIM IN CONNECTION WITH SUCH ACTION, SUIT OR PROCEEDING IF IT IS FOUND AND DETERMINED BY THE BOARD OR A COURT OF COMPETENT JURISDICTION THAT HE (1) ACTED IN GOOD FAITH AND IN A MANNER HE REASONABLY BELIEVED TO BE IN, OR NOT OPPOSED TO, THE BEST INTERESTS OF THE ASSOCIATION, OR (2) WITH RESPECT TO ANY CRIMINAL ACTION OR PROCEEDING, HAD NO REASONABLE CAUSE TO BELIEVE HIS CONDUCT WAS UNLAWFUL. THE TERMINATION OF ANY ACTION, SUIT OR PROCEEDING BY SETTLEMENT, OR UPON A PLEA OF *NOLO CONTENDERE* OR ITS EQUIVALENT, WILL NOT OF ITSELF CREATE A PRESUMPTION THAT THE PERSON DID NOT ACT IN GOOD FAITH OR IN A MANNER WHICH WAS REASONABLY BELIEVED TO BE IN, OR NOT OPPOSED TO, THE BEST INTERESTS OF THE ASSOCIATION OR, WITH RESPECT TO ANY CRIMINAL ACTION OR PROCEEDING, HAD REASONABLE CAUSE TO BELIEVE THAT HIS CONDUCT WAS UNLAWFUL. THE ASSOCIATION AGREES TO HOLD HARMLESS, DEFEND, AND INDEMNIFY DECLARANT, DECLARANT'S LENDER(S), AND DECLARANT'S RESPECTIVE AFFILIATES (DIRECT AND INDIRECT), PARENTS, JOINT VENTURERS, PARTNERS, MEMBERS, MANAGERS, AGENTS, CONTRACTORS, REPRESENTATIVES, OFFICERS, DIRECTORS, EMPLOYEES, AND STAFF (COLLECTIVELY, THE "RELEASED PARTIES"), FROM ANY CLAIMS, CAUSES OF ACTION, DEMANDS, LOSSES, DAMAGES, EXPENSES, COSTS, AND CLAIMS FOR PERSONAL INJURY, ILLNESS OR PROPERTY DAMAGE, INCLUDING DEATH (THE "CLAIMS"), ARISING OUT OF OR RELATING IN ANY WAY TO ANY ASSOCIATION ACTIVITIES, FUNCTIONS, COMPLETED PRODUCTS OR OPERATIONS, INCLUDING, BUT NOT LIMITED TO, THE OPERATION, MAINTENANCE OR REPAIR OF ANY COMMON AREA OR ANY OTHER PORTION OF THE PROPERTY WHICH THE ASSOCIATION OWNS OR IS OTHERWISE HELD BY OR FOR THE BENEFIT OF THE ASSOCIATION, INCLUDING WITHOUT LIMITATION PORTIONS HELD UNDER ANY LEASE, LICENSE OR EASEMENT IN FAVOR OF THE ASSOCIATION, OR THE EXERCISE OF ANY RIGHTS CONFERRED UPON THE ASSOCIATION IN THE RESTRICTIONS.

4.08 Insurance. The Board may purchase and cause to be maintained, at the expense of the Association, insurance on behalf of any person who is acting as a director, officer, committee member, employee, servant or agent of the Association against any liability asserted against him or incurred by him in any such capacity, or arising out of his status as such, whether or not the Association would have the power to indemnify him against such liability or otherwise.

4.09 Bulk Rate Contracts. Without limitation on the generality of the Association powers set out in *Section 4.05* hereinabove (except that during the Development Period, all Bulk

Rate Contracts must be approved in advance and in writing by the Declarant), the Association will have the power to enter into Bulk Rate Contracts at any time and from time to time. The Association may enter into Bulk Rate Contracts with any service providers chosen by the Board (including Declarant, and/or any entities in which Declarant, or the owners or partners of Declarant are owners or participants, directly or indirectly). The Bulk Rate Contracts may be entered into on such terms and provisions as the Board may determine in its sole and absolute discretion. The Association may, at its option and election, add the charges payable by such Owner under such Bulk Rate Contract to the Assessments against such Owner's Lot. In this regard, it is agreed and understood that, if any Owner fails to pay any charges due by such Owner under the terms of any Bulk Rate Contract, then the Association will be entitled to collect such charges by exercising the same rights and remedies it would be entitled to exercise under this Declaration with respect to the failure by such Owner to pay Assessments, including without limitation the right to foreclose the lien against such Owner's Lot which is reserved under the terms and provisions of this Declaration. In addition, in the event of nonpayment by any Owner of any charges due under any Bulk Rate Contract and after the lapse of at least twelve (12) days since such charges were due, the Association may, upon five (5) days' prior written notice to such Owner (which may run concurrently with such 12 day period), in addition to all other rights and remedies available at law, equity or otherwise, terminate, in such manner as the Board deems appropriate, any utility service or other service provided at the cost of the Association and not paid for by such Owner (or the Resident of such Owner's Lot) directly to the applicable service or utility provider. Such notice will consist of a separate mailing or hand delivery at least five (5) days prior to a stated date of termination, with the title "termination notice" or similar language prominently displayed on the notice. The notice will include the office or street address where the Owner (or the Resident of such Owner's Lot) can make arrangements for payment of the bill and for re-connection or re-institution of service. No utility or cable television service will be disconnected on a day, or immediately preceding a day, when personnel are not available for the purpose of collection and reconnecting such services.

4.10 Community Systems. The Association is specifically authorized to provide, or to enter into contracts with other Persons to provide Community Systems. Any such contracts may provide for installation, operation, management, maintenance, and upgrades or modifications to the Community Systems as the Board determines appropriate. Each Owner acknowledges that interruptions in cable television and other Community Systems and services will occur from time to time. Declarant and the Association, or any of their respective successors or assigns shall not be liable for, and no Community System or service user shall be entitled to refund, rebate, discount, or offset in applicable fees for, any interruption in Community Systems and services, regardless of whether or not such interruption is caused by reasons within the service provider's control. In addition, until expiration or termination of the Development Period, any contracts entered pursuant to this *Section 4.09* must be approved in advance and in writing by the Declarant.

4.11 Protection of Declarant's Interests. Despite any assumption of control of the Board by Owners other than Declarant, until the expiration or termination of the Development Period, the Board is prohibited from taking any action which would discriminate against

Declarant, or which would be detrimental to the sale of Lots owned by Declarant. Declarant shall be entitled to determine, in its sole and absolute discretion, whether any such action discriminates or is detrimental to Declarant. The Board will be required to continue the same level and quality of maintenance, operations and services as that provided immediately prior to assumption of control of the Board by Owners other than Declarant until the expiration or termination of the Development Period.

4.12 Administration of Common Area. The administration of the Common Area by the Association shall be in accordance with the provisions of Texas law and the Restrictions, and of any other agreements, documents, amendments or supplements to the foregoing which may be duly adopted or subsequently required by any institutional or governmental lender, purchaser, insurer or guarantor of mortgage loans (including, for example, the Federal Home Loan Mortgage Corporation) designated by Declarant or by any governmental or quasi-governmental agency having regulatory jurisdiction over the Common Area or by any title insurance company selected by Declarant to insure title to any portion of the Common Area.

ARTICLE 5 INSURANCE

5.01 Insurance. Each Owner will be required to purchase and maintain commercially standard insurance on the Improvements located upon such Owner's Lot. The Association will not be required to maintain insurance on the Improvements constructed upon any Lot. The Association may, however, obtain such insurance as it may deem necessary, including but not limited to such policies of liability and property damage insurance as the Board, in its discretion, may deem necessary. Insurance premiums for such policies will be a common expense to be included in the assessments levied by the Association. The acquisition of insurance by the Association will be without prejudice to the right and obligation of any Owner to obtain additional individual insurance. During the Development Period, Declarant reserves the right to satisfy the insurance obligations of the Association with a master insurance program controlled by Declarant.

ARE YOU COVERED?

The Association will not provide insurance which covers an Owner's Lot or any Improvements or personal property located on a Lot.

5.02 Restoration. In the event of any fire or other casualty, unless otherwise approved by the ACC, the Owner will promptly repair, restore and replace any damaged or destroyed structures to their same exterior condition existing prior to the damage or destruction thereof. Such repair, restoration or replacement will be commenced and completed in a good and workmanlike manner using exterior materials identical to those originally used in the structures damaged or destroyed. To the extent that the Owner fails to commence such repair, restoration or replacement of substantial or total damage or destruction within one hundred

and twenty (120) days after the occurrence of such damage or destruction, and thereafter prosecute same to completion, or if the Owner does not clean up any debris resulting from any damage within thirty (30) days after the occurrence of such damage, the Association may commence, complete or effect such repair, restoration, replacement or clean-up, and such Owner will be personally liable to the Association for the cost of such work; provided, however, that if the Owner is prohibited or delayed by law, regulation or administrative or public body or tribunal from commencing such repair, restoration, replacement or clean-up, the rights of the Association under this provision will not arise until the expiration of thirty (30) days after such prohibition or delay is removed. If the Owner fails to pay such cost upon demand by the Association, the cost thereof (plus interest from the date of demand until paid at the maximum lawful rate, or if there is no such maximum lawful rate, than at the rate of one and one-half percent (1½%) per month) will be added to the Assessment chargeable to the Owner's Lot. Any such amounts added to the Assessments chargeable against a Lot will be secured by the liens reserved in the Declaration for Assessments and may be collected by any means provided in this Declaration for the collection of Assessments, including, but not limited to, foreclosure of such liens against the Owner's Lot. **EACH SUCH OWNER WILL INDEMNIFY AND HOLD HARMLESS THE ASSOCIATION AND ITS OFFICERS, DIRECTORS, COMMITTEE MEMBERS, EMPLOYEES AND AGENTS FROM ANY COST, LOSS, DAMAGE, EXPENSE, LIABILITY, CLAIM OR CAUSE OF ACTION INCURRED OR THAT MAY ARISE BY REASON OF THE ASSOCIATION'S ACTS OR ACTIVITIES UNDER THIS SECTION 5.02, EXCEPT FOR SUCH COST, LOSS, DAMAGE, EXPENSE, LIABILITY, CLAIM OR COST OF ACTION ARISING BY REASON OF THE ASSOCIATION'S GROSS NEGLIGENCE OR WILLFUL MISCONDUCT. "GROSS NEGLIGENCE" AS USED HEREIN DOES NOT INCLUDE SIMPLE NEGLIGENCE, CONTRIBUTORY NEGLIGENCE OR SIMILAR NEGLIGENCE SHORT OF ACTUAL GROSS NEGLIGENCE.**

5.03 Mechanic's and Materialmen's Lien. Each Owner whose structure is repaired, restored, replaced or cleaned up by the Association pursuant to the rights granted under this *Article 5*, hereby grants to the Association an express mechanic's and materialmen's lien for the reasonable cost of such repair, restoration, or replacement of the damaged or destroyed Improvement to the extent that the cost of such repair, restoration or replacement exceeds any insurance proceeds allocable to such repair, restoration or replacement and delivered to the Association. Upon request by the Board, and before the commencement of any reconstruction, repair, restoration or replacement, such Owner will execute all documents sufficient to effectuate such mechanic's and materialmen's lien in favor of the Association.

ARTICLE 6 COVENANT FOR ASSESSMENTS

6.01 Assessments.

(a) Established by Board. Assessments established by the Board pursuant to the provisions of this *Article 6* will be levied against each Lot in amounts determined

pursuant to *Section 6.07* below. The total amount of Assessments will be determined by the Board pursuant to *Section 6.03, 6.04, 6.05, and/or 6.06*.

(b) Personal Obligation; Lien. Each Assessment, together with such interest thereon and costs of collection as hereinafter provided, will be the personal obligation of the Owner of the Lot against which the Assessment is levied and will be secured by a lien hereby granted and conveyed by Declarant to the Association against each such Lot and all Improvements thereon. The Association may enforce payment of such Assessments in accordance with the provisions of this Article.

(c) Declarant Subsidy. Declarant may, *but is not obligated to*, reduce Assessments which would otherwise be levied against Lots for any fiscal year by the payment of a subsidy to the Association. Any subsidy paid to the Association by Declarant may be treated as a contribution or a loan, in Declarant's sole and absolute discretion. Any subsidy and the characterization thereof will be disclosed as a line item in the annual budget prepared by the Board and attributable to such Assessments. The payment of a subsidy in any given year will not obligate Declarant to continue payment of a subsidy to the Association in future years.

6.02 Maintenance Fund. The Board will establish a maintenance fund into which will be deposited all monies paid to the Association and from which disbursements will be made in performing the functions of the Association under this Declaration. The funds of the Association may be used for any purpose authorized by the Restrictions and the Texas Business Organizations Code, as each may from time to time be amended.

6.03 Regular Annual Assessments. Prior to the beginning of each fiscal year, the Board will estimate the expenses to be incurred by the Association during such year in performing its functions and exercising its powers under this Declaration, including, but not limited to, the cost of all management, repair and maintenance, the cost of providing street and other lighting, the cost of administering and enforcing the Restrictions, and will estimate the amount needed to maintain a reasonable provision for contingencies and an appropriate replacement reserve, and will give due consideration to any expected income and any surplus from the prior year's fund. Assessments sufficient to pay such estimated net expenses will then be levied at the level of Assessments set by the Board in its sole and absolute discretion, and the Board's determination will be final and binding so long as it is made in good faith. If the sums collected prove inadequate for any reason, including nonpayment of any Assessment, the Association may at any time, and from time to time, levy further Assessments in the same manner. All such regular Assessments will be due and payable to the Association annually on or before the first day of the month at the beginning of the fiscal year, or in such other manner as the Board may designate in its sole and absolute discretion.

6.04 Working Capital Assessment. Each Owner (other than Declarant) of a Lot will pay a one-time working capital assessment to the Association in the amount equal to two months of Regular Assessments. Such working capital assessment need not be uniform among

all Lots, and the Board is expressly authorized to levy working capital assessments of varying amounts depending on the size, use and general character of the Lots then being made subject to such levy.

Notwithstanding the foregoing provision, the following transfers will not be subject to the working capital assessment: (i) foreclosure of a deed of trust lien, tax lien, or the Association's assessment lien; (ii) transfer to, from, or by the Association; (iii) voluntary transfer by an Owner to one or more co-owners, or to the Owner's spouse, child, or parent. Additionally, an Owner who (i) is a Homebuilder; or (ii) acquires a Lot for the purpose of resale to a Homebuilder (a "**Development Owner**") will not be subject to the working capital assessment; however, the working capital assessment will be payable by any Owner who acquires a Lot from a Development Owner for residential living purposes or by any Owner who: (i) acquires a Lot and is not in the business of constructing single-family residences for resale to a third party; or (ii) who acquires the Lot for any purpose other than constructing a single-family residence thereon for resale to a third party. In the event of any dispute regarding the application of the working capital assessment to a particular Owner, the Declarant during the Development Period, and thereafter the Board, determination regarding the application of the exception will be binding and conclusive without regard to any contrary interpretation of this *Section 6.04*. The working capital assessment will be in addition to, not in lieu of, any other assessments levied in accordance with this *Article 6* and will not be considered an advance payment of such assessments. The working capital assessment hereunder will be due and payable by the transferee to the Association immediately upon each transfer of title to the Lot, including upon transfer of title from one Owner of such Lot to any subsequent purchaser or transferee thereof. The Declarant during the Development Period, and thereafter the Board, will have the power to waive the payment of any working capital assessment attributable to a Lot (or all Lots) by the Recordation of a waiver notice, which waiver may be temporary or permanent.

6.05 Special Assessments. In addition to the regular annual Assessments provided for above, the Board may levy special Assessments whenever in the Board's opinion such special Assessments are necessary to enable the Board to carry out the functions of the Association under this Declaration. The amount of any special Assessments will be at the reasonable discretion of the Board. In addition to the special Assessments authorized above, the Association may, in any fiscal year, levy a special Assessment applicable to that fiscal year only for the purpose of defraying, in whole or in part, the cost of any construction, reconstruction, repair or replacement of a capital improvement upon the Common Area. Any special Assessment levied by the Association for the purpose of defraying, in whole or in part, costs of any construction, reconstruction, repair or replacement of capital improvement upon the Common Area will be levied against all Owners based on Assessment Units.

6.06 Individual Assessments. In addition to any other Assessments, the Board may levy an Individual Assessment against an Owner and the Owner's Lot. Individual Assessments may include, but are not limited to: interest, late charges, and collection costs on delinquent Assessments; reimbursement for costs incurred in bringing an Owner or the Owner's Lot into

compliance with the Declaration; fines for violations of the Declaration; transfer-related fees and resale certificate fees; fees for estoppel letters and project documents; insurance deductibles; reimbursement for damage or waste caused by willful or negligent acts of the Owner, the Owner's guests, invitees or residents of the Owner's Lot; common expenses that benefit fewer than all of the Lots, which may be assessed according to benefit received; fees or charges levied against the Association on a per-Lot basis; and "pass through" expenses for services to Lots provided through the Association and which are equitably paid by each Lot according to the benefit received.

6.07 Amount of Assessment.

(a) Assessments to be Levied. The Board shall levy Assessments against each "Assessment Unit" (as defined in *Section 6.07(b)* below). Unless otherwise provided in this Declaration, Assessments levied pursuant to *Section 6.03* and *Section 6.05* shall be levied uniformly against each Assessment Unit allocated to a Lot.

(b) Assessment Unit. Each Lot shall constitute one "Assessment Unit" unless otherwise provided in *Section 6.07(c)*.

(c) Assessment Exemption. Notwithstanding anything in this Declaration to the contrary, no Assessments shall be levied upon Lots owned by Declarant or any Homebuilders.

(d) Other Exemptions. Declarant may, in its sole discretion, elect to: (i) exempt any un-platted or unimproved portion of the Property or any Lot from any Assessments levied or charged pursuant to this *Article 6*; or (ii) delay the levy of Assessments against any un-platted, unimproved or improved portion of the Property. Declarant or the Board may also exempt any portion of the Property which is dedicated and accepted by public authority from Assessments.

6.08 Late Charges. If any Assessment is not paid by the due date applicable thereto, the Owner responsible for the payment may be required by the Board, at the Board's election at any time and from time to time, to pay a late charge in such amount as the Board may designate, and the late charge (and any reasonable handling costs) will be levied as an Individual Assessment against the Lot owned by such Owner, collectible in the manner as provided for collection of Assessments, including foreclosure of the lien against such Lot; provided, however, such charge will never exceed the maximum charge permitted under Applicable Law.

6.09 Owner's Personal Obligation; Interest. Assessments levied as provided for herein will be the personal and individual debt of the Owner of the Lot against which are levied such Assessments. No Owner may exempt himself from liability for such Assessments. In the event of default in the payment of any such Assessment, the Owner of the Lot will be obligated to pay interest on the amount of the Assessment at the highest rate allowed by applicable usury

laws then in effect on the amount of the Assessment from the due date therefor (or if there is no such highest rate, then at the rate of one and one half percent (1 1/2%) per month), together with all costs and expenses of collection, including reasonable attorneys' fees. Such amounts will be levied as an Individual Assessment against the Lot owned by such Owner.

6.10 Assessment Lien and Foreclosure. The payment of all sums assessed in the manner provided in this Article is, together with late charges as provided in *Section 6.08* and interest as provided in *Section 6.09* hereof and all costs of collection, including attorney's fees as herein provided, secured by the continuing Assessment lien granted to the Association pursuant to *Section 6.01(b)* above, and will bind each Lot in the hands of the Owner thereof, and such Owner's heirs, devisees, personal representatives, successors or assigns. The aforesaid lien will be superior to all other liens and charges against such Lot, except only for: (i) tax liens; (ii) all sums secured by a first mortgage lien or first deed of trust lien of record, to the extent such lien secures sums borrowed for the acquisition or improvement of the Lot in question and (iii) home equity loans or home equity lines of credit which are secured by a second mortgage lien or second deed of trust lien of record; provided that, in the case of subparagraphs (ii) and (iii) above, such Mortgage was Recorded before the delinquent Assessment was due. The Association will have the power to subordinate the aforesaid Assessment lien to any other lien. Such power will be entirely discretionary with the Board, and such subordination may be signed by an officer of the Association. The Association may, at its option and without prejudice to the priority or enforceability of the Assessment lien granted hereunder, prepare a written notice of Assessment lien setting forth the amount of the unpaid indebtedness, the name of the Owner of the Lot covered by such lien and a description of the Lot. Such notice may be signed by one of the officers of the Association and will be Recorded. Each Owner, by accepting a deed or ownership interest to a Lot subject to this Declaration, will be deemed conclusively to have granted a power of sale to the Association to secure and enforce the Assessment lien granted hereunder. The Assessment liens and rights to foreclosure thereof will be in addition to and not in substitution of any other rights and remedies the Association may have by law and under this Declaration, including the rights of the Association to institute suit against such Owner personally obligated to pay the Assessment and/or for foreclosure of the aforesaid lien. In any foreclosure proceeding, such Owner will be required to pay the costs, expenses and reasonable attorney's fees incurred. The Association will have the power to bid (in cash or by credit against the amount secured by the lien) on the property at foreclosure or other legal sale and to acquire, hold, lease, mortgage, convey or otherwise deal with the same. Upon the written request of any Mortgagee, the Association will report to said Mortgagee any unpaid Assessments remaining unpaid for longer than sixty (60) days after the same are due. The lien hereunder will not be affected by the sale or transfer of any Lot; except, however, that in the event of foreclosure of any lien superior to the Assessment lien, the lien for any Assessments that were due and payable before the foreclosure sale will be extinguished, provided that past-due Assessments will be paid out of the proceeds of such foreclosure sale only to the extent that funds are available after the satisfaction of the indebtedness secured by the Mortgage. The provisions of the preceding sentence will not, however, relieve any subsequent Owner (including any Mortgagee or other purchaser at a foreclosure sale) from

paying Assessments becoming due and payable after the foreclosure sale. Upon payment of all sums secured by a lien of the type described in this *Section 6.10*, the Association will upon the request of the Owner execute a release of lien relating to any lien for which written notice has been filed as provided above, except in circumstances in which the Association has already foreclosed such lien. Such release will be signed by an officer of the Association. In addition to the lien hereby retained, in the event of nonpayment by any Owner of any Assessment and after the lapse of at least twelve (12) days since such payment was due, the Association may, upon five (5) days' prior written notice (which may run concurrently with such 12 day period) to such Owner, in addition to all other rights and remedies available at law, equity or otherwise, terminate, in such manner as the Board deems appropriate, any utility or cable service provided through the Association and not paid for directly by a Owner or occupant to the utility provider. Such notice will consist of a separate mailing or hand delivery at least five (5) days prior to a stated date of disconnection, with the title "termination notice" or similar language prominently displayed on the notice. The notice will include the office or street address where the Owner or the Owner's tenant can make arrangements for payment of the bill and for reconnection of service. Utility or cable service will not be disconnected on a day, or immediately preceding a day, when personnel are not available for the purpose of collection and reconnecting such services. Except as otherwise provided by Applicable Law, the sale or transfer of a Lot will not relieve the Owner of such Lot or such Owner's transferee from liability for any Assessments thereafter becoming due or from the lien associated therewith. If an Owner conveys its Lot and on the date of such conveyance Assessments against the Lot remain unpaid, or said Owner owes other sums or fees under this Declaration to the Association, the Owner will pay such amounts to the Association out of the sales price of the Lot, and such sums will be paid in preference to any other charges against the Lot other than liens superior to the Assessment lien and charges in favor of the State of Texas or a political subdivision thereof for taxes on the Lot which are due and unpaid. The Owner conveying such Lot will remain personally liable for all such sums until the same are fully paid, regardless of whether the transferee of the Lot also assumes the obligation to pay such amounts. The Board may adopt an administrative transfer fee to cover the expenses associated with updating the Association's records upon the transfer of a Lot to a third party; provided, however, that no transfer fee will be due upon the transfer of a Lot from Declarant to a third party.

Yes, the Association can foreclose on your Lot!
If you fail to pay assessments to the Association, you may lose title to your Lot if the Association forecloses its assessment lien.

6.11 Exempt Property. The following area within the Property will be exempt from the Assessments provided for in this Article:

- (a) All area dedicated and accepted by public authority, by the Recordation of an appropriate document;
- (b) The Common Area; and

(c) Any portion of the Property owned by Declarant or, the Association.

6.12 Fines and Damages Assessment.

(a) Board Assessment. The Board may assess fines against an Owner for violations of the Restrictions which have been committed by an Owner, a Resident, or the Owner or Resident's guests, agents or invitees. Any fine and/or charge for damage levied in accordance with this *Section 6.12* will be considered an Individual Assessment pursuant to this Declaration. Each day of violation may be considered a separate violation if the violation continues after written notice to the Owner. The Board may assess damage charges against an Owner for pecuniary loss to the Association from property damage or destruction of Common Area or any facilities located by the Owner, Resident, or their guests, agents, or invitees. The Manager will have authority to send notices to alleged violators, informing them of their violations and asking them to comply with the Rules and Regulations and/or informing them of potential or probable fines or damage assessments. The Board may from time to time adopt a schedule of fines.

(b) Procedure. Before levying a fine, the Association will give the Owner a written violation notice via certified mail, return receipt requested, and an opportunity to be heard, if requested by the Owner. This requirement may not be waived. The Association's written violation notice will contain the following items: (i) the date the violation notice is prepared or mailed; (ii) a description of the violation or property damage that is the basis for the suspension action, charge, or fine and state any amount due to the Association from the Owner; (iii) a reference to the rule or provision that is being violated; (iv) a description of the action required to cure the violation; (v) the timeframe in which the violation is required to be cured to avoid the fine or suspension; (vi) the amount of the fine; (vii) a statement that no later than the thirtieth (30th) day after receiving the notice, the Owner may request a hearing pursuant to Section 209.007 of the Texas Property Code, and further, if the hearing held pursuant to Section 209.007 of the Texas Property Code is to be held by a committee appointed by the Board, a statement notifying the Owner that he or she has the right to appeal the committee's decision to the Board by written notice to the Board; and (viii) a statement informing the Owner that they may have special rights or relief related to the enforcement action under federal law, including the Servicemembers Civil Relief Act (50 U.S.C. app. section et seq), if the Owner is serving on active military duty. The notice sent out pursuant to this paragraph is further subject to the following:

A. First Violation. If the Owner has not been given notice and a reasonable opportunity to cure the same or similar violation within the preceding six (6) months, the notice will state those items set out in (i) – (viii) above, along with a specific timeframe by which the violation must be cured to avoid the fine. The notice must state that any future violation of the same rule may result in the levy of a fine.

- B. Repeat Violation – No Cure within 6 Months. If the Owner has been given notice and a reasonable opportunity to cure the same or similar violation within the preceding six (6) months but commits the violation again, the notice will state those items set out in (i) - (iii), (vi) and (viii) above, but will also state that because the Owner has been given notice and a reasonable opportunity to cure the same or similar violation within the preceding six (6) months but has not cured the violation, then the Owner will be fined pursuant to the *Schedule of Fines* described in the Community Manual.
- C. Continuous Violation. After an Owner has been notified of a violation as set forth herein and assessed fines in the amounts set forth in Schedule of Fines described in the Community Manual, if the Owner has never cured the violation in response to either the notices or the fines, in its sole discretion, the Board may determine that such a circumstance is a continuous violation which warrants a levy of a fine based upon a daily, monthly, or quarterly amount as determined by the Board.

(c) Due Date. Fine and/or damage charges are due immediately after the later of: (i) the date that the cure period set out in the First Violation notice ends and the Owner does not attempt to cure the violation or the attempted cure is unacceptable to Association; or (2) if a hearing is requested by the Owner, such fines or damage charges will be due immediately after the Board's final decision on the matter, assuming that a fine or damage charge of some amount is confirmed by the Board at such hearing.

(d) Lien Created. The payment of each fine and/or damage charge levied by the Board against the Owner of a Lot is, together with interest as provided in *Section 6.09* hereof and all costs of collection, including attorney's fees as herein provided, secured by the lien granted to the Association pursuant to *Section 6.01(b)* of this Declaration. Unless otherwise provided in this *Section 6.12*, the fine and/or damage charge will be considered an Assessment for the purpose of this Article, and will be enforced in accordance with the terms and provisions governing the enforcement of assessments pursuant to this *Article 6*.

ARTICLE 7 ARCHITECTURAL CONTROL COMMITTEE

Declarant has a substantial interest in ensuring that Improvements within the Property maintain and enhance Declarant's reputation as a community developer and do not impair Declarant's ability to market and sell all or any portion of the Property. Until Declarant has delegated its right to appoint and remove all members of the ACC to the Board as provided in *Section 7.02(a)* below, the ACC will be acting solely in Declarant's interest and will owe no duty to any other Owner or the Association. Notwithstanding any provision in this Declaration to the contrary, Declarant may appoint a single person to exercise the rights of the ACC.

7.01 **Construction of Improvements.** No Improvement may be erected, placed, constructed, painted, altered, modified or remodeled on any Lot, and no Lot may be re-subdivided or consolidated with other Lots or Property, by anyone other than Declarant without the prior written approval of the ACC. Declarant may construct any Improvements on any Lot or the Property without the consent of the ACC.

7.02 **Architectural Control Committee.**

(a) **Composition.** The ACC will be composed of not more than three (3) persons (who need not be Members or Owners) appointed as provided below, who will review Improvements proposed to be made by any Owner other than Declarant. Declarant will have the right to appoint and remove (with or without cause) all members of the ACC. Declarant may assign its right to appoint all members of the ACC to the Association by Recorded written instrument, and thereafter, the Board will have the right to appoint and remove (with or without cause) all members of the ACC. Any assignment by Declarant of the right to appoint and remove all members of the ACC may be withdrawn until expiration of twelve (12) months after the expiration of the Development Period. If Declarant withdraws its assignment of the right to appoint and remove all members of the ACC, then on the date of such withdrawal, Declarant will have the right to appoint and remove (with or without cause) all members of the ACC. **Declarant's right to appoint all members of the ACC will automatically be assigned to the Association upon the expiration of twelve (12) months after the expiration of the Development Period.** Declarant, at its option, may create and assign specific duties and responsibilities to one or more sub-committees consisting of members and/or nonmembers of the ACC. In the event responsibilities and duties are assigned to a sub-committee, those responsibilities and duties will no longer be discharged by the ACC unless the sub-committee exercising such duties and responsibilities is dissolved by Declarant. The right to create, dissolve, and appoint members of such sub-committees will reside exclusively with Declarant until such time as Declarant has assigned its right to appoint members of the ACC to the Association. The ACC will have the right to employ consultants and advisors as it deems necessary or appropriate.

(b) **Submission and Approval of Plans and Specifications.** Construction plans and specifications or, when an Owner desires solely to re-subdivide or consolidate Lots, a proposal for such re-subdivision or consolidation, will be submitted in accordance with the Design Guidelines, if adopted, or any additional rules adopted by the ACC together with any review fee which is imposed by the ACC in accordance with *Section 7.02(c)* to the ACC at the offices of Declarant, at such address as may hereafter be designated in writing from time to time. No re-subdivision or consolidation will be made, nor any Improvement placed or allowed on any Lot, until the plans and specifications and the builder which the Owner intends to use to construct the proposed structure or Improvement have been approved in writing by a Majority of the members of the ACC. The ACC may, in reviewing such plans and specifications consider any information that it deems proper; including, without limitation, any permits,

environmental impact statements or percolation tests that may be required by the ACC or any other entity; and harmony of external design and location in relation to surrounding structures, topography, vegetation, and finished grade elevation. The ACC may postpone its review of any plans and specifications submitted for approval pending receipt of any information or material which the ACC, in its sole discretion, may require. Site plans must be approved by the ACC prior to the clearing of any Lot, or the construction of any Improvements. The ACC may refuse to approve plans and specifications for proposed Improvements, or for the re-subdivision or consolidation of any Lot on any grounds that, in the sole and absolute discretion of the ACC, are deemed sufficient, including, but not limited to, purely aesthetic grounds.

Notwithstanding any provision to the contrary in the Declaration, the ACC may issue an approval to Homebuilders for the construction of Improvements based on the review and approval of plan types and adopt a procedure which differs from the procedures for review and approval set forth in this Declaration.

(c) Design Guidelines. Declarant may adopt the initial Design Guidelines and, during the Development Period, will have the power from time to time, to adopt (unless previously adopted by Declarant), amend, modify, or supplement the Design Guidelines. Upon expiration or termination of the Development Period, the ACC, or any sub-committee thereof created pursuant to *Section 7.02(a)*, will have the power from time to time, to amend, modify, or supplement the Design Guidelines; provided, however, that any amendment to the Design Guidelines made by a sub-committee will only apply to the Improvements under the jurisdiction of such sub-committee, and during the Development Period, any such amendment, modification or supplement must be approved in advance and in writing by the Declarant. In the event of any conflict between the terms and provisions of the Design Guidelines and the terms and provisions of this Declaration, the terms and provisions of this Declaration will control. In addition, the ACC will have the power and authority to impose a fee, not to exceed \$50.00 per application, for the review of plans, specifications and other documents and information submitted to it pursuant to the terms of this Declaration. Such charges will be held by the ACC and used to defray the administrative expenses incurred by the ACC in performing its duties hereunder; provided, however, that any excess funds held by the ACC will be distributed to the Association at the end of each calendar year. The ACC will not be required to review any plans until a complete submittal package, as required by this Declaration and the Design Guidelines, is assembled and submitted to the ACC. The ACC will have the authority to adopt such additional procedural and substantive rules and guidelines (including, without limitation, the imposition of any requirements for certificates of compliance or completion relating to any Improvement and the right to approve in advance any contractor selected for the construction of Improvements), not in conflict with this Declaration, as it may deem necessary or appropriate in connection with the performance of its duties hereunder.

(d) Actions of the Architectural Control Committee. The ACC may, by resolution unanimously adopted in writing, designate one or more of its members, or an agent acting on its behalf, to take any action or perform any duties for and on behalf of the ACC, except the granting of variances. In the absence of such designation, the vote of a Majority of all of the members of the ACC taken at a duly constituted meeting will constitute an act of the ACC.

(e) Failure to Act. In the event that any plans and specifications are submitted to the ACC as provided herein, and the ACC fails either to approve or reject such plans and specifications for a period of twenty-five (25) days following such submission, rejection of such plans and specifications by the ACC will be presumed. In furtherance, and not in limitation, of the foregoing, any failure of the ACC to act upon a request for a variance will not be deemed a consent to such variance, and the ACC's written approval of all requests for variances will be expressly required.

(f) Variances. The ACC may grant variances from compliance with any of the provisions of the Design Guidelines or this Declaration, when, in the opinion of the ACC, in its sole and absolute discretion, such variance is justified. All variances must be evidenced in writing and must be signed by at least a Majority of the members of the ACC. Each variance must also be Recorded; provided however, that failure to record a variance will not affect the validity thereof or give rise to any claim or cause of action against the ACC, including the Declarant or its designee, the Association, or the Board. If a variance is granted, no violation of the covenants, conditions, or restrictions contained in this Declaration or the Design Guidelines will be deemed to have occurred with respect to the matter for which the variance was granted. The granting of such variance will not operate to waive or amend any of the terms and provisions of this Declaration or the Design Guidelines for any purpose except as to the particular property and in the particular instance covered by the variance, and such variance will not be considered to establish a precedent for any future waiver, modification, or amendment of the terms and provisions of this Declaration or the Design Guidelines.

(g) Duration of Approval. The approval of the ACC of any plans and specifications ,and any variances granted by the ACC, will be valid for a period of one hundred and eighty (180) days only. If construction in accordance with such plans and specifications or variance is not commenced within such one hundred and eighty (180) day period and diligently prosecuted to completion within either: (i) one year after issuance of approval of such plans and specifications; or (ii) such other period thereafter as determined by the ACC, in its sole and absolute discretion,, the Owner will be required to resubmit such plans and specifications or request for a variance to the ACC, and the ACC will have the authority to re-evaluate such plans and specifications in accordance with this *Section 7.02(g)* and may, in addition, consider any change in circumstances which may have occurred since the time of the original approval.

(h) No Waiver of Future Approvals. The approval of the ACC to any plans or specifications for any work done or proposed in connection with any matter requiring the approval or consent of the ACC will not be deemed to constitute a waiver of any right to withhold approval or consent as to any plans and specifications on any other matter, subsequently or additionally submitted for approval by the same or a different person, nor will such approval or consent be deemed to establish a precedent for future approvals by the ACC.

(i) Non-Liability of Committee Members. NEITHER DECLARANT, THE BOARD, THE ARCHITECTURAL CONTROL COMMITTEE, NOR ANY MEMBER WILL BE LIABLE TO ANY OWNER OR TO ANY OTHER PERSON FOR ANY LOSS, DAMAGE OR INJURY ARISING OUT OF THE PERFORMANCE OF THE ARCHITECTURAL CONTROL COMMITTEE'S DUTIES UNDER THIS DECLARATION, UNLESS SUCH LOSS, DAMAGE, OR INJURY IS DUE TO THE WILLFUL MISCONDUCT OR BAD FAITH OF THE ARCHITECTURAL CONTROL COMMITTEE OR ONE OR MORE OF ITS MEMBERS, AS THE CASE MAY BE.

ARTICLE 8 MORTGAGE PROVISIONS

The following provisions are for the benefit of holders, insurers and guarantors of first Mortgages on Lots within the Property. The provisions of this Article apply to the Declaration and the Bylaws of the Association.

8.01 Notice of Action. An institutional holder, insurer, or guarantor of a first Mortgage which provides a written request to the Association (such request to state the name and address of such holder, insurer, or guarantor and the street address of the Lot to which its Mortgage relates (thereby becoming an "**Eligible Mortgage Holder**"), will be entitled to timely written notice of:

(a) Any condemnation loss or any casualty loss which affects a material portion of the Property or which affects any Lot on which there is an Eligible Mortgage held, insured, or guaranteed by such Eligible Mortgage Holder; or

(b) Any delinquency in the payment of assessments or charges owed for a Lot subject to the Mortgage of such Eligible Mortgage Holder, where such delinquency has continued for a period of sixty (60) days, or any other violation of the Restrictions relating to such Lot or the Owner or Resident which is not cured within sixty (60) days; or

(c) Any lapse, cancellation, or material modification of any insurance policy maintained by the Association.

8.02 Examination of Books. The Association will permit Mortgagees to examine the books and records of the Association during normal business hours.

8.03 Taxes, Assessments and Charges. All taxes, assessments and charges that may become liens prior to first lien mortgages under Applicable Law will relate only to the individual Lots and not to any other portion of the Property.

**ARTICLE 9
GENERAL PROVISIONS**

9.01 Term. The terms, covenants, conditions, restrictions, easements, charges, and liens set out in this Declaration will run with and bind the Property, and will inure to the benefit of and be enforceable by the Association, and every Owner, including Declarant, and their respective legal representatives, heirs, successors, and assigns, for a term beginning on the date this Declaration is Recorded, and continuing through and including January 1, 2077, after which time this Declaration will be automatically extended for successive periods of ten (10) years unless a change (the word "change" meaning a termination, or change of term or renewal term) is approved in a resolution adopted by Members entitled to cast at least sixty-seven percent (67%) of the total number of votes of the Association, voting in person or by proxy at a meeting duly called for such purpose, written notice of which will be given to all Members at least thirty (30) days in advance and will set forth the purpose of such meeting; provided, however, that such change will be effective only upon the Recording of a certified copy of such resolution. The foregoing sentence shall in no way be interpreted to mean sixty-seven percent (67%) of a quorum as established pursuant to the Bylaws.

9.02 Eminent Domain. In the event it becomes necessary for any public authority to acquire all or any part of the Common Area for any public purpose during the period this Declaration is in effect, the Board is hereby authorized to negotiate with such public authority for such acquisition and to execute instruments necessary for that purpose. Should acquisitions by eminent domain become necessary, only the Board need be made a party, and in any event the proceeds received will be held by the Association for the benefit of the Owners. In the event any proceeds attributable to acquisition of Common Area are paid to Owners, such payments will be allocated on the basis of Assessment Units and paid jointly to the Owners and the holders of Mortgages or deeds of trust on the respective Lot.

9.03 Amendment. This Declaration may be amended or terminated by the Recording of an instrument executed and acknowledged by: (i) Declarant acting alone, during the Development Period; or (ii) by the president and secretary of the Association setting forth the amendment and certifying that such amendment has been approved by Declarant (until expiration or termination of the Development Period) and Members entitled to cast at least sixty-seven percent (67%) of the number of votes entitled to be cast by members of the Association. The foregoing sentence shall in no way be interpreted to mean sixty-seven percent (67%) of a quorum as established pursuant to the Bylaws. No amendment will be effective without the written consent of Declarant, its successors or assigns, during the Development Period. Specifically, and by no means by way of limitation, Declarant may unilaterally amend this Declaration: (a) to bring any provision into compliance with any applicable governmental statute, rule, regulation, or judicial determination; (b) to enable any reputable title insurance

company to issue title insurance coverage on any Lot; (c) to enable any institutional or governmental lender, purchaser, insurer or guarantor of mortgage loans, including, for example, the Federal Home Loan Mortgage Corporation, to make, purchase, insure or guarantee mortgage loans on Lots; or (d) to comply with any requirements promulgated by a local, state or governmental agency, including, for example, the Department of Housing and Urban Development.

9.04 Roadway and Utility Easements. Declarant reserves the right to create, locate, relocate, construct, erect, and maintain or cause to be created, located, relocated, constructed, erected, and maintained in and on any portion of the Property then owned by Declarant or any streets maintained by the Association, or areas conveyed to the Association, or areas reserved or held as Common Area, roadways, sewer lines, water lines, electrical lines and conduits, and other pipelines, conduits, wires, and any public utility function beneath or above the surface of the ground with the right of access to the same at any time for the purposes of repair and maintenance.

9.05 Enforcement. EACH OWNER, BY ACCEPTING TITLE TO ALL OR ANY PORTION OF THE PROPERTY, HEREBY RELEASES AND SHALL HOLD HARMLESS EACH OF THE DECLARANT, THE ASSOCIATION, AND THEIR PARTNERS, DIRECTORS, OFFICERS, OR AGENTS FROM AND AGAINST ANY DAMAGES, CLAIMS, OR LIABILITY ASSOCIATED WITH THE FAILURE OF THE DECLARANT OR THE ASSOCIATION TO ENFORCE THE TERMS AND PROVISIONS OF THE RESTRICTIONS. The Association and the Declarant will have the right to enforce, by a proceeding at law or in equity, all restrictions, conditions, covenants, reservations, liens, charges and other terms now or hereafter imposed by the provisions of this Declaration. Failure to enforce any right, provision, covenant, or condition granted by this Declaration will not constitute a waiver of the right to enforce such right, provision, covenants or condition in the future.

9.06 Higher Authority. The terms and provisions of this Declaration are subordinate to federal and state law, and local ordinances. Generally, the terms and provisions of this Declaration are enforceable to the extent they do not violate or conflict with local, state, or federal law or ordinance.

9.07 Severability. If any provision of this Declaration is held to be invalid by any court of competent jurisdiction, such invalidity will not affect the validity of any other provision of this Declaration, or, to the extent permitted by Applicable Law, the validity of such provision as applied to any other person or entity.

9.08 Conflicts. If there is any conflict between the provisions of this Declaration, the Certificate, the Bylaws, or any Rules and Regulations adopted pursuant to the terms of such documents, the provisions of this Declaration, the Certificate, the Bylaws and the Rules and Regulations, in such order, will govern.

9.09 **Gender.** Whenever the context so requires, all words herein in the male gender will be deemed to include the female or neuter gender, all singular words will include the plural, and all plural words will include the singular.

9.10 **Acceptance by Grantees.** Each grantee of Declarant of a Lot or other real property interest in the Property, by the acceptance of a deed of conveyance, or each subsequent purchaser, accepts the same subject to all terms, restrictions, conditions, covenants, reservations, easements, liens and charges, and the jurisdiction rights and powers created or reserved by this Declaration or to whom this Declaration is subject, and all rights, benefits and privileges of every character hereby granted, created, reserved or declared. Furthermore, each grantee agrees that no assignee or successor to Declarant hereunder will have any liability for any act or omission of Declarant which occurred prior to the effective date of any such succession or assignment. All impositions and obligations hereby imposed will constitute covenants running with the land within the Property, and will bind any person having at any time any interest or estate in the Property, and will inure to the benefit of each Owner in like manner as though the provisions of this Declaration were recited and stipulated at length in each and every deed of conveyance.

9.11 **Damage and Destruction.**

(a) **Claims.** Promptly after damage or destruction by fire or other casualty to all or any part of the Common Area covered by insurance, the Board, or its duly authorized agent, will proceed with the filing and adjustment of all claims arising under such insurance and obtain reliable and detailed estimates of the cost of repair of the damage. Repair, as used in this *Section 9.11(a)*, means repairing or restoring the Common Area to substantially the same condition as existed prior to the fire or other casualty.

(b) **Repair Obligations.** Any damage to or destruction of the Common Area will be repaired unless a Majority of the Board decides within sixty (60) days after the casualty not to repair. If for any reason either the amount of the insurance proceeds to be paid as a result of such damage or destruction, or reliable and detailed estimates of the cost of repair, or both, are not made available to the Association within said period, then the period will be extended until such information will be made available.

(c) **Restoration.** In the event that it should be determined by the Board that the damage or destruction of the Common Area will not be repaired and no alternative Improvements are authorized, then the affected portion of the Common Area will be restored to its natural state and maintained as an undeveloped portion of the Common Area by the Association in a neat and attractive condition.

(d) **Special Assessment.** If insurance proceeds are paid to restore or repair any damaged or destroyed Common Area, and such proceeds are not sufficient to defray the cost of such repair or restoration, the Board will levy a special Assessment, as

provided in *Article 6*, against all Owners. Additional Assessments may be made in like manner at any time during or following the completion of any repair.

(e) Proceeds Payable to Owners. In the event that any proceeds of insurance policies are paid to Owners as a result of any damage or destruction to any Common Area, such payments will be allocated based on Assessment Units and paid jointly to the Owners and the holders of Mortgages or deeds of trust on their Lots.

9.12 No Partition. Except as may be permitted in this Declaration or amendments thereto, no physical partition of the Common Area or any part will be permitted, nor will any person acquiring any interest in the Property or any part seek any such judicial partition unless the Property in question has been removed from the provisions of this Declaration pursuant to *Section 11.04* below. This *Section 9.12* will not be construed to prohibit the Board from acquiring and disposing of tangible personal property or from acquiring title to real property that may or may not be subject to this Declaration, nor will this provision be constructed to prohibit or affect the creation of a condominium regime in accordance with the Texas Uniform Condominium Act.

9.13 Notices. Any notice permitted or required to be given to any person by this Declaration will be in writing and may be delivered either personally or by mail, or as otherwise required by Applicable Law. If delivery is made by mail, it will be deemed to have been delivered on the third (3rd) day (other than a Sunday or legal holiday) after a copy of the same has been deposited in the United States mail, postage prepaid, addressed to the person at the address given by such person to the Association for the purpose of service of notices. Such address may be changed from time to time by notice in writing given by such person to the Association.

9.14 View Impairment. Neither Declarant nor the Association guarantee or represent that any view over and across the Lots, or any open space or Common Area within the Property will be preserved without impairment. Neither the Declarant, the ACC, and the Association shall have no obligation to relocate, prune, or thin trees or other landscaping. The Association (with respect to any Common Area) will have the right to add trees and other landscaping from time to time, subject to Applicable Law. There shall be no express or implied easements for view purposes or for the passage of light and air.

9.15 Safety and Security. Each Owner and Resident of a Lot, and their respective guests and invitees, shall be responsible for their own personal safety and the security of their property within the Property. The Association may, but shall not be obligated to, maintain or support certain activities within the Property designed to promote or enhance the level of safety or security which each person provides for himself or herself and his or her property. However, neither the Association nor Declarant shall in any way be considered insurers or guarantors of safety or security within the Property, nor shall either be held liable for any loss or damage by reason of failure to provide adequate security or ineffectiveness of security measures undertaken.

**ARTICLE 10
EASEMENTS**

10.01 Right of Ingress and Egress. Declarant, its agents, employees and designees will have a right of ingress and egress over and the right of access to the Common Area to the extent necessary to use the Common Area and the right to such other temporary uses of the Common Area as may be required or reasonably desirable (as determined by Declarant in its sole discretion) in connection with the construction and development of the Property. The Property shall be subject to a perpetual non-exclusive easement for the installation and maintenance, including the right to read meters, service or repair lines and equipment, and to do everything and anything necessary to properly maintain and furnish the Community Systems and the facilities pertinent and necessary to the same, which easement shall run in favor of Declarant. Declarant shall have the right, but not the obligation, to install and provide the Community Systems and to provide the services available through the Community Systems to any and all Lots within the Property. Neither the Association nor any Owner shall have any interest therein. Any or all of such services may be provided either directly through the Association and paid for as part of the Assessments or directly to Declarant, any affiliate of Declarant, or a third party, by the Owner who receives the services. The Community Systems shall be the property of Declarant unless transferred by Declarant, whereupon any proceeds of such transfer shall belong to Declarant. Declarant shall have the right but not the obligation to convey, transfer, sell or assign all or any portion of the Community Systems or all or any portion of the rights, duties or obligations with respect thereto, to the Association or to any Person. The rights of Declarant with respect to the Community Systems installed by Declarant and the services provided through such Community Systems are exclusive, and no other Person may provide such services through the Community Systems installed by Declarant without the prior written consent of Declarant. In recognition of the fact that interruptions in cable television and other Community Systems services will occur from time to time, no person or entity described above shall in any manner be liable, and no user of any Community System shall be entitled to any refund, rebate, discount or offset in applicable fees, for any interruption in Community Systems services, regardless of whether or not same is caused by reasons within the control of the then-provider of such services.

10.02 Reserved Easements. All dedications, limitations, restrictions and reservations shown on any Plat and all grants and dedications of easements, rights-of-way, restrictions and related rights made by Declarant prior to the Property becoming subject to this Declaration are incorporated herein by reference and made a part of this Declaration for all purposes as if fully set forth herein, and will be construed as being adopted in each and every contract, deed or conveyance executed or to be executed by or on behalf of Declarant. Declarant reserves the right to relocate, make changes in, and additions to said easements, rights-of-way, dedications, limitations, reservations and grants for the purpose of most efficiently and economically developing the Property.

10.03 Utility Easements. Declarant hereby reserves unto itself and Declarant's successors and assigns a perpetual non-exclusive easement over and across the Property for:

(i) the installation, operation and maintenance of utilities and associated infrastructure to serve the Property and any other property owned by Declarant; (ii) the installation, operation and maintenance of cable lines and associated infrastructure for sending and receiving data and/or other electronic signals, security and similar services to serve the Property and any other property owned by Declarant; and (iii) the installation, operation and maintenance of, walkways, pathways and trails, drainage systems, street lights and signage to serve the Property and any other property owned by Declarant. Declarant will be entitled to unilaterally assign the easements reserved hereunder to any third party who owns, operates or maintains the facilities and Improvements described in (i) through (iii) of this *Section 10.03*. The exercise of the easement reserved herein will not extend to permitting entry into any residence, nor will it unreasonably interfere with the use of any Lot or residence or Improvement constructed thereon.

10.04 Subdivision Entry and Fencing Easement. Declarant reserves for itself and the Association, an easement over and across the Property for the installation, maintenance, repair or replacement of certain subdivision entry facilities and fencing which serves the Property. Declarant will have the right, from time to time, to Record a written notice which identifies the subdivision entry facilities fencing to which the easement reserved hereunder applies. Declarant may designate all or any portion of the subdivision entry facilities and/or fencing as Common Area by Recorded written notice. The exercise of the easements reserved hereunder will not extend to permitting entry into any residence, nor will it unreasonably interfere with the use of any Lot or residence or Improvement constructed thereon.

10.05 Landscape and Monument Sign Easement. Declarant hereby reserves for itself and the Association, an easement over and across the Property for the installation, maintenance, repair or replacement of a monument sign which serves the Property. Declarant will have the right, from time to time, to Record a written notice, which identifies those portions of the Property to which the easement reserved hereunder applies. Declarant designates the easement areas reserved hereunder as Common Area. The exercise of the easements reserved hereunder will not extend to permitting entry into any residence, nor will it unreasonably interfere with the use of any Lot or residence or Improvement constructed thereon.

10.06 Declarant as Attorney in Fact. To secure and facilitate Declarant's exercise of the rights reserved by Declarant pursuant to the terms and provisions of this Declaration, each Owner, by accepting a deed to a Lot and each Mortgagee, by accepting the benefits of a Mortgage against a Lot, and any other third party by acceptance of the benefits of a mortgage, deed of trust, mechanic's lien contract, mechanic's lien claim, vendor's lien and/or any other security interest against any Lot, will thereby be deemed to have appointed Declarant such Owner's, Mortgagee's, and third party's irrevocable attorney-in-fact, with full power of substitution, to do and perform, each and every act permitted or required to be performed by Declarant pursuant to the terms of this Declaration. The power thereby vested in Declarant as attorney-in-fact for each Owner, Mortgagee and/or third party, will be deemed, conclusively, to be coupled with an interest and will survive the dissolution, termination, insolvency, bankruptcy, incompetency and death of an Owner, Mortgagee and/or third party and will be

binding upon the legal representatives, administrators, executors, successors, heirs and assigns of each such party. The aforesaid power shall be vested in Declarant, its successors and assigns, for a period of twenty-five (25) years from the date the first Lot is conveyed to an individual purchaser, or until the expiration or termination of the Development Period, whichever occurs first. Declarant hereby reserves for itself, its successors and assigns the right to execute on behalf of each Owner, Mortgagee, and third party claiming a legal or equitable interest in the Common Area, any such agreements, documents, amendments or supplements to the Restrictions which may be required by any institutional or governmental lender, purchaser, insurer or guarantor of mortgage loans (including, for example, the Federal Home Loan Mortgage Corporation) designated by Declarant or by any governmental or quasi-governmental agency having regulatory jurisdiction over the Common Area or by any title insurance company selected by Declarant to insure title to any portion of the Common Area.

ARTICLE 11 DEVELOPMENT RIGHTS

11.01 Development by Declarant. It is contemplated that the Property will be developed pursuant to a plan, which may, from time to time, be amended or modified. Declarant reserves the right, but will not be obligated, to create and/or designate Lots and Common Areas and to subdivide with respect to any of the Property pursuant to the terms of this *Section 11.01*, subject to any limitations imposed on portions of the Property by any applicable Plat. These rights may be exercised with respect to any portions of the Property. As each area is developed or dedicated, Declarant may designate the use, classification and such additional covenants, conditions and restrictions as Declarant may deem appropriate for that area.

11.02 Special Declarant Rights. Notwithstanding any provision of this Declaration to the contrary, at all times, Declarant will have the right and privilege: (i) to erect and maintain advertising signs (illuminated or non-illuminated), sales flags, other sales devices and banners for the purpose of aiding the sale of Lots in the Property; (ii) to maintain Improvements upon Lots as sales, model, management, business and construction offices; and (iii) to maintain and locate construction trailers and construction tools and equipment within the Property. The construction, placement or maintenance of Improvements by Declarant will not be considered a nuisance, and Declarant hereby reserves the right and privilege for itself to conduct the activities enumerated in this *Section 11.02* until two (2) years after expiration or termination of the Development Period.

11.03 Addition of Land. Declarant may, at any time and from time to time, add additional lands to the Property. Upon the filing of a notice of addition of land, such land will be considered part of the Property for purposes of this Declaration, and such added lands will be considered part of the Property subject to this Declaration and the terms, covenants, conditions, restrictions and obligations set forth in this Declaration, and the rights, privileges, duties and liabilities of the persons subject to this Declaration will be the same with respect to such added land as with respect to the lands originally covered by this Declaration. To add

lands to the Property, Declarant will be required only to Record a notice of addition of land containing the following provisions:

- (a) A reference to this Declaration, which reference will state the volume and initial page number of the Official Public Records of Hays County wherein this Declaration is Recorded;
- (b) A statement that such land will be considered Property for purposes of this Declaration, and that all of the terms, covenants, conditions, restrictions and obligations of this Declaration will apply to the added land; and
- (c) A legal description of the added land.

11.04 Withdrawal of Land. Declarant may, at any time and from time to time, reduce or withdraw from the Property, and remove and exclude from the burden of this Declaration and the jurisdiction of the Association any portion of the Property. Upon any such withdrawal and renewal this Declaration and the covenants conditions, restrictions and obligations set forth herein will no longer apply to the portion of the Property withdrawn. To withdraw lands from the Property hereunder, Declarant will be required only to Record a notice of withdrawal of land containing the following provisions:

- (a) A reference to this Declaration, which reference will state the volume and initial page number of the Official Public Records of Hays County wherein this Declaration is recorded;
- (b) A statement that the provisions of this Declaration will no longer apply to the withdrawn land; and
- (c) A legal description of the withdrawn land.

11.05 Assignment of Declarant's Rights. Notwithstanding any provision in this Declaration to the contrary, Declarant may, by written instrument, assign, in whole or in part, any of its privileges, exemptions, rights and duties under this Declaration to any person or entity and may permit the participation, in whole, in part, exclusively, or non-exclusively, by any other person or entity in any of its privileges, exemptions, rights and duties hereunder.

ARTICLE 12 DISPUTE RESOLUTION

12.01 Agreement to Encourage Resolution of Disputes Without Litigation. This Article 12 may only be amended with the prior written approval of the Declarant, the Association (acting through a Majority of the Board), and Owners holding 80% of the votes in the Association.

(a) Bound Parties. Declarant, the Association and its officers, directors, and committee members, Owners, Homebuilders, and all other parties subject to this Declaration ("**Bound Party**", or collectively, the "**Bound Parties**"), agree that it is in the best interest of all concerned to encourage the amicable resolution of disputes involving the Property without the emotional and financial costs of litigation. Accordingly, each Bound Party agrees not to file suit in any court with respect to a Claim described in subsection (b), unless and until it has first submitted such Claim to the alternative dispute resolution procedures set forth in *Section 12.02* in a good faith effort to resolve such Claim.

(b) Claim(s). As used in this Article, the term "Claim" or "Claims" will refer to any claim, grievance or dispute arising out of or relating to:

(i) The interpretation, application, or enforcement of the Restrictions;
or

(ii) The rights, obligations, and duties of any Bound Party under the Restrictions; or

(iii) The design or construction of Improvements within the Property.

(c) Not Considered Claims. The following will not be considered "Claims" unless all parties to the matter otherwise agree to submit the matter to the procedures set forth in *Section 12.02*:

(i) Any legal proceeding by the Association to collect assessments or other amounts due from any Owner;

(ii) Any legal proceeding by the Association to obtain a temporary restraining order (or emergency equitable relief) and such ancillary relief as the court may deem necessary in order to maintain the status quo and preserve the Association's ability to enforce the provisions of this Declaration;

(iii) Any legal proceeding which does not include Declarant or the Association as a party, if such action asserts a Claim which would constitute a cause of action independent of the Restrictions;

(iv) Any legal proceeding in which any indispensable party is not a Bound Party;

(v) Any action by the Association to enforce the Restrictions; and

(vi) Any legal proceeding as to which any applicable statute of limitations would expire within one hundred and eighty (180) days of giving the Notice required by *Section 12.02 (a)*, unless the party or parties against whom the

Claim is made agree to toll the statute of limitations as to such Claim for such period as may reasonably be necessary to comply with this Article.

(d) Claim Affecting Common Area. Notwithstanding any term or provision in this Declaration to the contrary, the Association does not have the power or right to institute, defend, intervene in, settle, or compromise litigation, arbitration or other proceedings: (i) in the name of or on behalf of any Lot Owner (whether one or more); or (ii) pertaining to a Claim, as defined in *Section 12.01* above, relating to the design or construction of Improvements on a Lot (whether one or more). Additionally, no Lot Owner shall have the power or right to institute, defend, intervene in, settle or compromise litigation, arbitration or other proceedings relating to the design or construction of the Common Area. Each Lot Owner, by accepting an interest in or to title to a Lot, hereby grants to the Association the exclusive right to institute, defend, intervene in, settle or compromise litigation, arbitration or other proceedings relating to the design or construction of the Common Area. Unless otherwise approved by Members holding at least eighty percent (80%) of the votes in the Association, the Association, acting through its Board, shall in no event have the authority to engage a law firm or attorney to prosecute a Claim relating to the design or construction of the Common Area if the agreement between the Association and law firm or attorney includes any provision or requirement that would obligate the Association to pay any costs, expenses, fees, or other charges to the law firm or attorney, including but not limited to, costs, expenses, fees, or other charges payable by the Association: (i) if the Association terminates the engagement with the law firm or attorney or engages another firm or third-party to assist with the Claim; (ii) if the Association agrees to settle the Claim for a cash payment or in exchange for repairs or remediation performed by the Respondent or any other third-party; (iii) if the Association agrees to pay interest on any costs or expenses incurred by the law firm or attorney; and/or (iv) for consultants, expert witnesses, and/or general contractors hired by the law firm or attorney. For avoidance of doubt, it is intended that Members holding eighty percent (80%) of the votes in the Association must approve the law firm and attorney who will prosecute the Claim and the written agreement between the Association and the law firm and/or attorney.

12.02 Dispute Resolution Procedures.

(a) Notice. The Bound Party asserting a Claim (“**Claimant**”) against another Bound Party (“**Respondent**”) will give written notice to each Respondent and to the Board stating plainly and concisely:

(i) The nature of the Claim, including the Persons involved and the Respondent’s role in the Claim; and

(ii) The legal basis of the Claim (i.e., the specific authority out of which the Claim arises); and

(iii) The Claimant's proposed resolution or remedy; and

(iv) The Claimant's desire to meet with the Respondent to discuss in good faith ways to resolve the Claim.

(b) Negotiation. The Claimant and Respondent will make every reasonable effort to meet in person and confer for the purpose of resolving the Claim by good faith negotiation. If requested in writing, accompanied by a copy of the Notice, the Board may appoint a representative to assist the parties in negotiating a resolution of the Claim.

(c) Mediation. If the parties have not resolved the Claim through negotiation within thirty (30) days of the date of the notice described in *Section 12.02(a)* (or within such other period as the parties may agree upon), the Claimant will have thirty (30) additional days to submit the Claim to mediation with an entity designated by the Association (if the Association is not a party to the Claim) or if the Association is a party to the Claim, to an independent agency on which the parties mutually agree providing dispute resolution services in Hays County, Texas.

If the Claimant does not submit the Claim to mediation within such time, or does not appear for the mediation when scheduled, the Claimant will be deemed to have waived the Claim, and the Respondent will be relieved of any and all liability to the Claimant (but not third parties) on account of such Claim.

If the Parties do not settle the Claim within thirty (30) days after submission of the matter to mediation, or within such time as determined reasonable by the mediator, the mediator will issue a notice of termination of the mediation proceedings indicating that the parties are at an impasse and the date that mediation was terminated. The Claimant will thereafter be entitled to file suit or to initiate administrative proceedings on the Claim, as appropriate.

Each Party will bear its own costs of the mediation, including attorney's fees, and each Party will share equally all fees charged by the mediator.

(d) Settlement. Any settlement of the Claim through negotiation or mediation will be documented in writing and signed by the parties. If any party thereafter fails to abide by the terms of such agreement, then any other party may file suit or initiate administrative proceedings to enforce such agreement without the need to again comply with the procedures set forth in this Section. In such event, the party taking action to enforce the agreement or award will, upon prevailing, be entitled to recover from the non-complying party (or if more than one noncomplying party, from all such parties in equal proportions) all costs incurred in enforcing such agreement or award, including, without limitation, attorneys' fees and court costs.

[SIGNATURE PAGE FOLLOWS]

EXECUTED to be effective on the date this instrument is Recorded.

DECLARANT:

181 AND 1604 LAND DEVELOPMENT PARTNERS, LTD., a Texas limited partnership

By: 181 and 1604 GP, LLC,
a Texas limited liability company,
its general partner

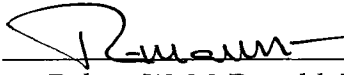
By: 
Robert W. McDonald, IV, Manager

THE STATE OF TEXAS §
 §
COUNTY OF Travis §

This instrument was acknowledged before me this 27th day of July 2021, by Robert W. McDonald, IV, Manager of 181 and 1604 GP, LLC, a Texas limited liability company, general partner of 181 and 1604 Land Development Partners, Ltd., a Texas limited partnership, on behalf of said entities.

(SEAL)

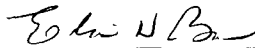
Notary Public Signature

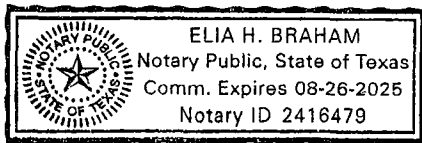

Exhibit "A"
The Property

A 986.26 acre tract of land, located in the Jose De La Garza Survey, Abstract 4, County Block 4008, Bexar County, Texas and being a portion of a called 1089.86 acre tract of land as conveyed and described in Document No. 20140148573 of the Official Public Records of Bexar County, Texas. Said 986.26 acre tract being more particularly described by metes and bounds as follows:

BEGINNING at a found $\frac{1}{2}$ " iron rod with a red plastic cap stamped "Cude" in the south right-of-way line of Loop 1604, a variable width right-of-way, as shown on the Texas Department of Transportation(TxDOT) Right-of-Way Map (R.O.W.), CSJ No. 2255-2-17, at the northeast corner of a called 3.00 acre tract of land as described in Document No. 20150242381 of the Official Public Records of Bexar County, Texas, for the most northerly northwest corner of said 1089.86 acre tract and the tract described herein, from which a found TxDOT R.O.W. Monument, Type I, for an angle in the south right-of-way line of Loop 1604 and the north line of said 3.00 acre tract bears, S 61° 11' 34" W, a distance of 23.14 feet;

THENCE: With the south right-of-way line of Loop 1604 and the north line of said 1089.86 acre tract, the following eight (8) courses:

1. N 61° 11' 34" E, a distance of 430.28 feet to a found TxDOT R.O.W. Monument, Type II, for an angle,
2. N 66° 19' 02" E, a distance of 700.00 feet to a found TxDOT R.O.W. Monument, Type I, for an angle,
3. S 78° 08' 42" E, a distance of 43.01 feet to a found TxDOT R.O.W. Monument, Type I, for an angle,
4. N 66° 19' 02" E, a distance of 65.00 feet to a found TxDOT R.O.W. Monument, Type I, for an angle,
5. N 30° 46' 46" E, a distance of 43.01 feet to a found TxDOT R.O.W. Monument, Type I, for angle,
6. N 66° 19' 02" E, a distance of 964.90 feet to a found TxDOT R.O.W. Monument, Type I, for angle,
7. N 69° 10' 13" E, a distance of 200.20 feet to a found TxDOT R.O.W. Monument, Type I, for angle, and
8. N 66° 18' 29" E, a distance of 160.00 feet to a found 12" wood fence post in the northeasterly line of an 80' Wide C.P.S. Electric Easement as described in Volume 18514, Page 396 of the Official Public Records of Bexar County, Texas and for the most northerly corner of the tract described herein;

THENCE: S 52° 58' 43" E, departing the south right-of-way line of Loop 1604, with said Easement and into said 1089.86 acre tract, a distance of 2265.72 feet to a point the intersection of the northeasterly line of said Easement and the northwesterly line of a 100' Wide C.P.S.B. Easement as described in Volume 7467, Page 418 of the Official Public Records of Bexar County, Texas, and for an interior corner of the tract described herein;

THENCE: N 58° 36' 48" E, with said northwesterly line of the 100' Wide C.P.S.B. Easement and continuing into said 1089.86 acre tract, a distance of 2443.95 feet to a point in the southwest right-of-way line of U.S. Highway 181, a variable width right-of-way, as shown the TxDOT R.O.W Map, CSJ No. 100-2-23, in the northeast line of said 1089.86 acre tract and for the northeasterly corner of the tract described herein, from which a found TxDOT R.O.W. Monument, Type I, for an angle in the southwest right-of-way line of U.S. Highway 181 bears, N 59° 56' 45" W, a distance of 985.59 feet, and also from which a found $\frac{1}{2}$ " iron rod bears, S 44° 25' 29" E, a distance of 0.51 feet;

THENCE: With the southwest right-of-way line of U.S. Highway 181 and the northeast line of said 1089.86 acre tract, the following two (2) courses:

1. S 67° 50' 46" E, a distance of 240.13 feet to a found TxDOT R.O.W. Monument, Type I, for an angle, and
2. S 59° 58' 06" E, a distance of 2092.45 feet to a point in the center of Calaveras Creek (this day surveyed), for the most easterly corner of said 1089.86 acre tract and the tract described herein;

THENCE: Departing the southwest right-of-way line of U.S. Highway 181 and with the meanders of the center of Calaveras Creek, the following courses:

- S 06° 37' 17" W, a distance of 111.70 feet to a point,
- S 16° 24' 25" W, a distance of 146.50 feet to a point,

- S 15° 38' 32" E, a distance of 105.27 feet to a point,
- S 08° 40' 42" W, a distance of 157.17 feet to a point,
- S 03° 10' 08" E, a distance of 104.41 feet to a point,
- S 28° 12' 04" W, a distance of 51.62 feet to a point,
- S 51° 51' 02" W, a distance of 65.22 feet to a point,
- S 89° 13' 20" W, a distance of 58.08 feet to a point,
- S 68° 22' 21" W, a distance of 134.93 feet to a point,
- S 15° 56' 04" W, a distance of 54.44 feet to a point,
- S 86° 28' 17" W, a distance of 50.67 feet to a point,
- S 57° 34' 49" W, a distance of 52.99 feet to a point,
- S 12° 42' 10" W, a distance of 339.57 feet to a point,
- S 21° 48' 51" W, a distance of 169.78 feet to a point,
- S 25° 43' 35" W, a distance of 76.68 feet to a point,
- S 09° 00' 46" W, a distance of 266.13 feet to a point,
- S 15° 07' 53" W, a distance of 201.83 feet to a point,
- S 15° 24' 20" W, a distance of 275.31 feet to a point,
- S 12° 14' 05" W, a distance of 204.93 feet to a point,
- S 07° 23' 46" W, a distance of 285.43 feet to a point,
- S 12° 19' 50" E, a distance of 254.91 feet to a point,
- S 08° 26' 55" E, a distance of 210.50 feet to a point,
- S 00° 17' 12" E, a distance of 196.57 feet to a point,
- S 12° 41' 49" W, a distance of 142.39 feet to a point,
- S 05° 58' 08" E, a distance of 425.51 feet to a point,
- S 03° 11' 34" W, a distance of 395.28 feet to a point,
- S 16° 20' 52" W, a distance of 174.74 feet to a point,
- S 11° 11' 34" W, a distance of 183.20 feet to a point,
- S 07° 34' 28" W, a distance of 18.52 feet to a point at the approximate intersection of Calaveras Creek and the Bexar/Wilson County Line and for an easterly corner of the tract described herein;

THENCE: S 36° 07' 26" W, departing the meanders of Calaveras Creek, and with the southeast line of said 1089.86 acre tract, a distance of 2001.60 feet to a found ½" iron rod with red plastic cap stamped "Cude" for the east corner of a called 2.073 acre tract, also known as Well Site #8, as described in Document No. 20200148165 of the Official Public Records of Bexar County, Texas, and for a southerly corner of the tract described herein;

THENCE: With the northerly, westerly and southerly lines of said 2.073 acre tract, the following three (3) courses:

1. N 53° 51' 28" W, a distance of 300.94 feet to a found ½" iron rod with red plastic cap stamped "Cude" for corner,
2. S 36° 08' 32" W, a distance of 300.00 feet to a found ½" iron rod with red plastic cap stamped "Cude" for corner, and
3. S 53° 51' 28" E, a distance of 301.04 feet to a found ½" iron rod with red plastic cap stamped "Cude" in the southeast line of said 1089.86 acre tract, approximately in said county line, for the south corner of said 2.073 acre tract and for a southerly corner of the tract described herein;

THENCE: S 36° 07' 26" W, with said approximate county line and the southeast line of said 1089.86 acre tract, a distance of 138.58 feet to a found ½" iron rod at the southeast corner of a called 19.850 acre tract of land as described in Volume 4916, Page 1710 of the Official Public Records of Bexar County, Texas, for the most southerly corner of said 1089.86 acre tract and the tract described herein;

THENCE: With the common line between said 19.850 acre tract and said 1089.86 acre tract, the following two (2) courses:

1. N 31° 46' 59" W, a distance of 1322.18 feet to a found ½" iron rod with red plastic cap stamped "Cude" for corner, and
2. S 58° 14' 22" W, a distance of 496.88 feet to a found ½" iron rod with red plastic cap stamped "Cude" at the northwest corner of said 19.850 acre tract, in the northeast line of a called 2.217 acre tract of land as described in Volume 5197, Page 512 of the Official Public Records of Bexar County, Texas, for a southerly corner of said 1089.86 acre tract and the tract described herein;

THENCE: N 24° 18' 24" W, with the northeast lines of two 2.217 acre tracts of land as described in Document No. 2020011394, a 2.217 acre tract as described in Document No. 20180155090 and a 2.244 acre tract of land as described in Document No. 20200046589, all of the Official Public Records of Bexar County, Texas and a southwest line of said 1089.86 acre tract, a distance of 909.78 feet to a found ½" iron rod at the north corner of said 2.244 acre tract, the southeast corner of a called 8.7293 acre tract of land as described in Volume 3803, Page 577 of the Real Property Records of Bexar County, Texas, for an angle of said 1089.86 acre tract and the tract described herein;

THENCE: N 23° 45' 11" W, with the northeast line of said 8.7293 acre tract and a called 0.4284 acre tract as described in Volume 4061, Page 1340 of the Real Property Records of Bexar County, Texas, and a southwest line of said 1089.86 acre tract, a distance of 843.50 feet to a found ½" iron rod for an angle in the northeast line of said 0.4284 acre tract, an angle of said 1089.86 acre tract and the tract described herein;

THENCE: N 24° 51' 44" W, with the northeast line of said 0.4284 acre tract, the northeast line of a called 4.3646 acre tract of land as described in Volume 4061, Page 1347 of the Real Property Records of Bexar County, Texas, and a southwest line of said 1089.86 acre tract, a distance of 568.22 feet to a found 5/8" iron rod in concrete at the northeast corner of said 4.3646 acre tract, for an interior corner of said 1089.86 acre tract and the tract described herein;

THENCE: S 66° 07' 58" W, with the northwest line of said 4.3646 acre tract and a southerly line of said 1089.86 acre tract, a distance of 542.32 feet to a found 5/8" iron rod in concrete at the northwest corner of said 4.3646 acre tract, for the north corner of Lot 32 of the Elm Arbor Ranchettes Subdivision of record in Volume 9555, Pages 157-159 of the Deed and Plat Records of Bexar County, Texas, for an angle of said 1089.86 acre tract and the tract described herein;

THENCE: With the southerly lines of said 1089.86 acre tract and the northwesterly lines of said Subdivision, the following four (4) courses:

1. S 53° 25' 40" W, a distance of 604.63 feet to a found ½" iron rod with red plastic cap stamped "Cude" for corner,
2. S 32° 37' 33" W, a distance of 596.36 feet to a found ½" iron rod with a red plastic cap stamped "4540" for corner,
3. S 32° 44' 39" W, a distance of 1246.08 feet to a set ½" iron rod with a red plastic cap stamped "Matkin Hoover Eng. & Survey" for corner, and
4. S 32° 42' 55" W, at 789.00 feet a found ½" iron rod with a red plastic cap stamped "Cude", and continuing for a total distance of 789.98 feet to a point for the most westerly corner of Lot 24 of said Subdivision, in the east line of a called 10.545 acre tract of land as described in Volume 6327, Page 1227 of the Official Public Records of Bexar County, Texas, for the southwest corner of said 1089.86 acre tract and the tract described herein, from which a found ¾" iron rod in concrete for the southeast corner of said 10.545 acre tract and the southwest corner of said Lot 24 bears, S 24° 10' 25" E, a distance of 80.91 feet;

THENCE: With the common line between said 10.545 acre tract and said 1089.86 acre tract, the following three (3) courses:

1. N 24° 10' 40" W, a distance of 458.90 feet to a found ½" iron rod for an angle,
2. N 24° 28' 46" W, a distance of 863.57 feet to a found ½" iron rod with a red plastic cap stamped "Cude" for an angle, and
3. N 24° 21' 46" W, a distance of 1023.82 feet to a found ½" iron rod with a red plastic cap stamped "Cude" for the north corner of said 10.545 acre tract, the northeast corner of a called 1.000 acre tract of land as described in

Volume 9433, Page 2301 of the Official Public Records of Bexar County, Texas, in the easterly line of a called 88.010 acre tract of land as described in Document No. 20180019370 of the Official Public Records of Bexar County, Texas, for an angle in the west line of said 1089.86 acre tract and the tract described herein;

THENCE: With the easterly line of said 88.010 acre tract and the westerly line of said 1089.86 acre tract, the following four (4) courses:

1. N 11° 52' 37" W, a distance of 954.86 feet to a 4" x 4" concrete monument for an angle,
2. N 11° 47' 04" W, a distance of 288.20 feet to a found ½" iron rod for an angle.
3. N 11° 18' 34" W, a distance of 1089.49 feet to a found ½" iron rod with a red plastic cap stamped "Cude" for an angle, and
4. N 12° 09' 41" W, a distance of 1564.97 feet to a found ½" iron rod with a red plastic cap stamped "4540" at the south corner of said 3.00 acre tract, for a westerly corner of said 1089.86 acre tract and the tract described herein:

THENCE: With the common line between said 3.00 acre tract and said 1089.86 acre tract, the following two (2) courses:

1. N 55° 25' 53" E, a distance of 379.30 feet to a found ½" iron rod with a red plastic cap stamped "4540" for corner, and
2. N 12° 14' 21" W, a distance of 364.44 feet to the POINT OF BEGINNING and containing 986.26 acres of land situated in Bexar County, Texas. SAVE AND EXCEPT, a called 0.271 acre tract of land, known as the Elevated Storage Tank Site, as described in Document No. 20200142310, a called 4.067 acre tract of land, known as the Water Production Facility Easement, as described in Document No. 20200142307, a called 2.066 acre tract of land, known as Well Site #9, as described in Document No. 20200142311, and a called 2.066 acre tract of land, known as Well Site #10, as described in Document No. 20200142304, all of the Official Public Records of Bexar County, Texas.

Exhibit "B"
Conceptual Plan

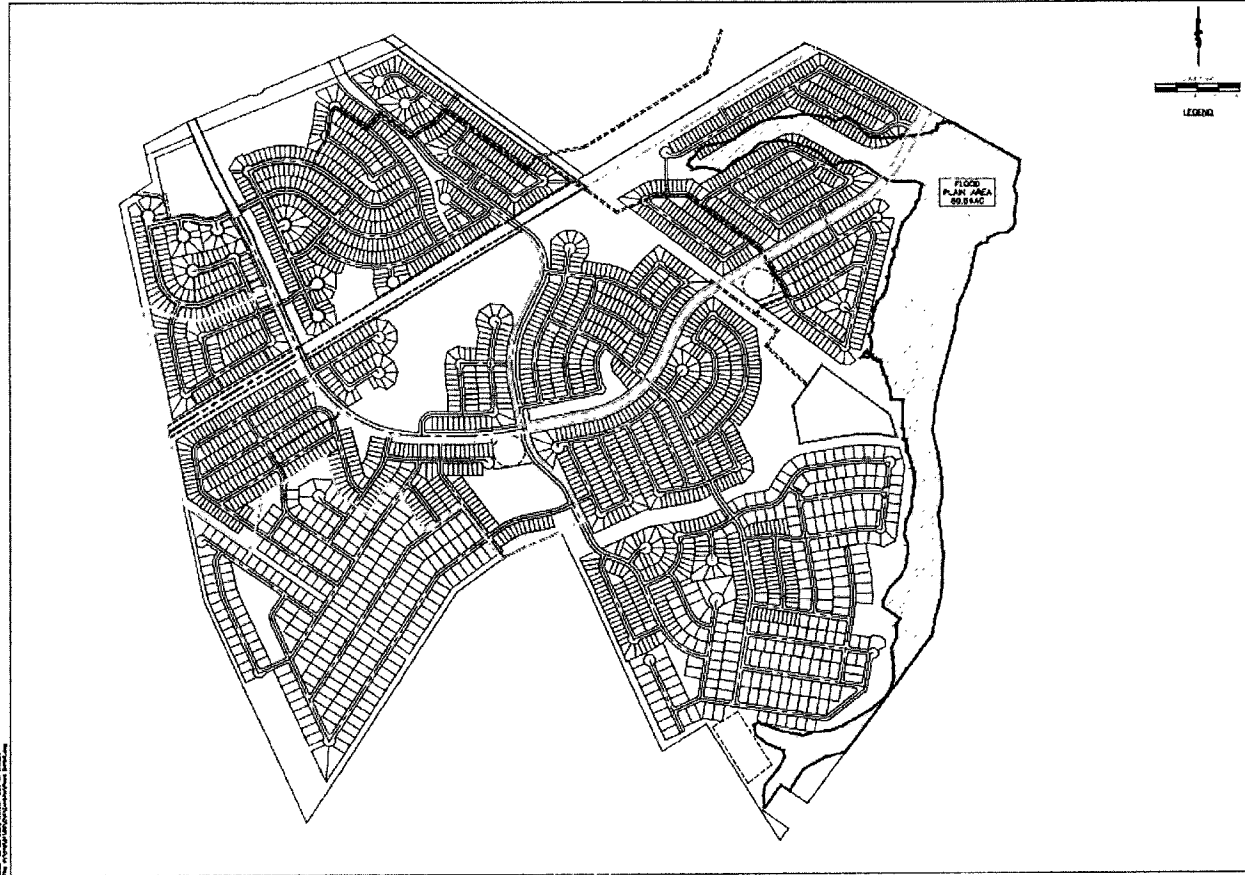

File Information

**eFILED IN THE OFFICIAL PUBLIC eRECORDS OF BEXAR COUNTY
LUCY ADAME-CLARK, BEXAR COUNTY CLERK**

Document Number: 20210210099
Recorded Date: July 30, 2021
Recorded Time: 4:59 PM
Total Pages: 68
Total Fees: \$290.00

**** THIS PAGE IS PART OF THE DOCUMENT ****

**** Do Not Remove ****

Any provision herein which restricts the sale or use of the described real property because of race is invalid and unenforceable under Federal law

STATE OF TEXAS, COUNTY OF BEXAR

I hereby Certify that this instrument was eFILED in File Number Sequence on this date and at the time stamped hereon by me and was duly eRECORDED in the Official Public Record of Bexar County, Texas on: 7/30/2021 4:59 PM



Lucy Adame-Clark
Lucy Adame-Clark
Bexar County Clerk